



FINAL PROGRAM

NAACCR ANNUAL CONFERENCE
JUNE 9 – 14, 2018

WYNDHAM GRAND
PITTSBURGH, PENNSYLVANIA



20
18



BRIDGING THE PATH TO THE
FUTURE OF CANCER SURVEILLANCE

naaccr.org

SPONSOR + EXHIBITORS

2018 NAACCR ANNUAL CONFERENCE SPONSOR

Novo Nordisk



100 College Road West
Princeton, NJ 08540
📞 Daniel Muss
☎ 215.591.2880
✉ daniel.muss@ubc.com

2018 NAACCR ANNUAL CONFERENCE EXHIBITORS

American Cancer Society



250 Williams Street NW
Atlanta, GA 30303
📞 Rebecca Siegel
☎ 404.329.7992
✉ rebecca.siegel@cancer.org

Artificial Intelligence in Medicine Inc.



2 Berkeley Street, Suite 403
Toronto, ON M5A 2W3
Canada
📞 Victor Brunka
☎ 866.645.2224
✉ vbrunka@aim.ca

Centers for Disease Control and Prevention – NPCR



Division of Cancer Prevention and Control
4770 Buford Highway NE, Mail Stop F-76
Atlanta, GA 30341
☎ 800.232.4636
🌐 www.cdc.gov/cancer/npcr

Elekta



400 Perimeter Center Terrace, Suite 50
Atlanta, GA 30346
📞 Lori Minton
☎ 770.670.2374
✉ Lori.Minton@Elekta.com

Harmony Healthcare LLC



2909 W Bay to Bay Boulevard, Suite 500
Tampa, FL 33629
📞 Cindy Kell
☎ 813.369.5165
✉ ckell@harmony.solutions

Health Language Analytics Global



Suite 4, International Business Centre
2 Cornwallis Street
Eveleigh, NSW Australia. 2016
📞 Professor Jon Patrick
☎ 61.4.9033.9787
✉ jon.patrick@hlaglobal.com
📞 Maryellen Galbally
☎ 61.2.8091.2690
✉ maiellen@iinet.net.au

ICF

9300 Lee Highway
Fairfax, VA 22031
☎ Chris Bishop
☎ 301.407.6756
✉ Chris.Bishop@icf.com
☎ Kevin Zhang
☎ 301.407.6708
✉ Kevin.Zhang@icf.com

Information Management Services, Inc.

Information Management Services, Inc.

3901 Calverton Boulevard, Suite 200
Calverton, MD 20705
☎ David Annett
☎ 301.680.9770
✉ annettd@imsweb.com

Kentucky Cancer Registry

2365 Harrodsburg Road, Suite A150
Lexington, KY 40504
☎ Eric Durbin
☎ 859.218.3182
✉ ericd@kcr.uky.edu

National Cancer Registrars Association

1330 Braddock Place, Suite 520
Alexandria, VA 22314-1650
☎ Lori Swain
☎ 703.299.6640 x 313
✉ lswain@ncra-usa.org

NCI SEER

9609 Medical Center Drive
Rockville, MD 20892
☎ Andrea Ayers
☎ 240.276.6881
✉ andrea.ayers@nih.gov
☎ Serban Negoita
☎ 240.276.5409
✉ Serban.Negoita@nih.gov

North American Association of Central Cancer Registries

2050 W. Iles Avenue, Suite A
Springfield, IL 62704
☎ Monica Thornton
☎ 217.698.0800
✉ mthornton@naaccr.org

RTI Health Solutions

200 Park Offices Drive
Research Triangle Park, NC 27709
☎ David Harris
☎ 919.541.7493
✉ dharris@rti.org
☎ Samantha Herring
☎ 919.541.6043
✉ sherring@rti.org

Westat

1600 Research Boulevard
Rockville, MD 20850
☎ Marsha Dunn
☎ 301.251.1500
✉ marshadunn@westat.com
☎ Kelly Kennedy
☎ 301.251.1500
✉ Kellykennedy@westat.com



PRESIDENT

Dr. Antoinette Stroup (2017-2019)
New Jersey State Cancer Registry
☎ 732.235.7422
✉ nan.stroup@rutgers.edu



PAST PRESIDENT

Dr. Charles Wiggins (2017-2018)
New Mexico Tumor Registry
☎ 505.272.3127
✉ cwiggins@salud.unm.edu



TREASURER

Maria J. Schymura (2017-2019)
New York State Cancer Registry
☎ 518.474.2255
✉ maria.schymura@health.ny.gov



EX-OFFICIO

Betsy A. Kohler, MPH, CTR
NAACCR, Inc. / Executive Director
☎ 217.698.0800 x 2
✉ bkohler@naaccr.org



REPRESENTATIVE, SPONSORING MEMBER ORGANIZATIONS

Lori Swain (2014-2018)
National Cancer Registrars Association
☎ 703.299.6640 x 313
✉ lswain@ncra-usa.org

REPRESENTATIVES-AT-LARGE



Francis P. Boscoe, PhD (2014-2018)
New York State Cancer Registry Riverview Center
☎ 518.474.2255
✉ francis.boscoe@health.ny.gov



Isaac Hands (2017-2019)
Kentucky Cancer Registry
☎ 859.218.3196
✉ isaac@kcr.uky.edu



Christopher Johnson, MPH (2014-2018)
Cancer Data Registry of Idaho
☎ 208.489.1380
✉ cjohnson@teamiha.org



Deirdre Rogers, PhD, CTR (2015-2019)
Mississippi Cancer Registry
☎ 601.815.5479
✉ dbrogers@umc.edu



Randi K. Rycroft, MSPH, CTR (2017-2019)
Colorado Central Cancer Registry
☎ 303.692.2542
✉ randi.rycroft@state.co.us



Heather Stuart-Panko, CHIM (2016-2018)
Saskatchewan Cancer Agency
☎ 639.625.2042
✉ heather.stuart-panko@saskcancer.ca

NAACCR 2018 ANNUAL CONFERENCE PROGRAM COMMITTEE MEMBERS

Thanks to all the members of the 2018 Program Committee for their time and guidance in planning the 2018 conference!

Chair: Wendy Aldinger, Pennsylvania Cancer Registry

Vickie Benard, Centers for Disease Control and Prevention
Charlie Blackburn, NAACCR
Castine Clerkin, NAACCR
Brenda Edwards, National Cancer Institute
Susan Gershman, Massachusetts Cancer Registry
Jim Hofferkamp, NAACCR
Ahmedin Jemal, American Cancer Society
Betsy Kohler, NAACCR
Mary Lewis, Centers for Disease Control and Prevention
Angela Martin, NAACCR

Lisa Paddock, New Jersey Cancer Registry
Lynne Penberthy, National Cancer Institute
Rich Pinder, Los Angeles Cancer Surveillance Program
Lisa Richardson, Centers for Disease Control and Prevention
Randi Rycroft, Colorado Central Cancer Registry
Antoinette Stroup, New Jersey Cancer Registry
Heather Stuart-Panko, Saskatchewan Cancer Agency
Evelyn Talbott, University of Pittsburgh Medical Center
Monica Thornton, NAACCR
Chuck Wiggins, New Mexico Tumor Registry
Melanie Williams, Texas Cancer Registry
Sharon Winters, University of Pittsburgh Medical Center

Welcome to the City of Bridges!

On behalf of the 2018 NAACCR Program Committee, the NAACCR Board of Directors, and, of course, Wendy Aldinger and the Pennsylvania Cancer Registry, I would like to welcome you to Pittsburgh, PA.

As its nickname suggests, Pittsburgh is a city of bridges... 446 to be exact. It is situated where the Monongahela and Allegheny Rivers meet to form the Ohio River in southeastern Pennsylvania. According to the Heinz History Center, the first river crossing bridge was built in 1818; but, before the bridges were built, settlers had to navigate "a rugged terrain of deep valleys, creeks, and rivers, isolating many of the city's residents." Our conference theme of **"Bridging the Path to the Future of Cancer Surveillance"** echoes Pittsburgh's history, setting the stage for the NAACCR community to create connections and to bridge different disciplines so that we are no longer working in isolation but rather generating shared solutions that will advance cancer surveillance and cancer research. This is our hope for this year's conference.

To that end, many of the themes throughout the conference center on bridging knowledge gaps between cancer registrars, computer programmers and computer engineers, informaticists, epidemiologists, data scientists, biostatisticians, geographers, medical and clinical experts, and many others. The conference week actually begins with an interdisciplinary group at our inaugural **Cancer Informatics Hackathon: Forging Solutions for Cancer Control**, where computer programmers and cancer registry experts will dare to hack their way through cancer control software problems. Hacks will be presented and judged on Monday, June 11 at 5:00pm outside the Exhibit Hall and awards will be announced on the final day of the conference, Thursday, June 14.

Our Keynote Speaker on Day 1 bridges cancer and courage. In his talk, "Cancer Registry is a Marathon", Matt Jones will use his experience as a 3-time cancer survivor and marathon runner to encourage, motivate, and inspire our community toward personal and professional success. During our plenary sessions we will hear speakers talk about **Bridging to the Future of Cancer Surveillance** through advances in precision medicine and immunotherapy, updated laws and regulations, new data sources, and cancer control and better measurement of clinical care and patient-reported outcomes. We will also have concurrent sessions that span several disciplines but all bridge the gaps in cancer surveillance including:

- The Long and Winding Road: Natural Language Processing (1-C)
- Finding Home: Advances in Residential History Data (1-D)
- Global Perspectives on Survival (2-B)
- On the Path to XML (2-C)
- Bridging the Timeliness Gap (2-D)
- Cancer Disparities Tools: SEER HD*Calc Tool (2-E)
- Virtual Pooled Registry Cancer Linkage System (3-C)
- Biomarkers & Tissue Repositories (4-E)
- Data Visualization (5-D)

We are also continuing our **Young Talks** from last year's conference, which will be held during session breaks; but, make a note that **Birds of a Feather "Doing More with Less"** is scheduled from 5:30pm-6:30pm at the end of Day 1, Tuesday, June 12 and the **Business Meeting** is scheduled from 8:15am-8:45am the morning of Day 2, Wednesday, June 13.

#NAACCR2018 is not all work and no play – don't forget about the **Explore Pittsburgh Bike Tour** on Day 2, Wednesday, June 13, our **NAACCR Fun Run/Walk** (6:30am, Day 3, Thursday, June 14) and all the interesting sites and experiences around Pittsburgh including The Andy Warhol Museum, Carnegie Science Center, and the Strip District.

Before I close, I'd like to thank each of you for attending the conference and hope that we can continue to build and fortify the bridges that we have created in our NAACCR community!

Sincerely,

Nan Stroup
New Jersey State Cancer Registry
NAACCR Board President

* Smith, Brady. "Pittsburgh: The City of Bridges". Making History, The Heinz History Center Blog. May 5, 2017:
<http://www.heinzhistorycenter.org/blog/western-pennsylvania-history/pittsburgh-the-city-of-bridges>

CONFERENCE INFORMATION

CONFERENCE REGISTRATION INFORMATION

The Conference Registration and Information Desk is located at the Ballroom level of the Wyndham Grand Pittsburgh Downtown and is open during the following days and times:

Monday, June 11	12:00pm to 7:00pm
Tuesday, June 12	7:00am to 5:00pm
Wednesday, June 13	7:30am to 11:45am
Thursday, June 14	7:00am to 11:30am

Pre Conference registration and check-in desks are located outside the Pre Conference rooms.

Any inquiries about the conference, social functions, etc., may be answered by any of the staff at the registration desk. Registered participants will receive their conference documents and badges at the registration desk. Please note that admission to the Opening Reception is by ticket only. Please be sure, you wear your name badge to all social events, workshops, and sessions.

SESSIONS

The Plenary Sessions will be held in the Grand Ballroom and Exhibits and Posters in the Ballroom 2, 3 and 4. Workshops and Concurrent Sessions will be held in King's Garden Rooms 1 to 5 on the Ballroom level.

OPENING RECEPTION

Tuesday, June 12, 2018

The Opening Reception will be held in the Grand Ballroom at 7:00pm. It serves as the perfect gathering place to enjoy networking, fabulous foods, and allows you to unwind and show your dance moves.

CONTINUING EDUCATION CREDITS

Continuing Education credit is provided by the National Cancer Registrars Association (NCRA). You will be able to conveniently download the 2018 NAACCR Annual Conference CE Hours Form from the NAACCR website at naaccr2018.org.

EXHIBITS AND POSTER INFORMATION

Exhibits and Posters will be located in Ballroom 2, 3 and 4 on the Ballroom level.

All delegates are encouraged to take the opportunity to visit the exhibits and posters to become familiar with some of the latest advances and research in the field.

They will be available at these times:

EXHIBIT HOURS

Monday, June 11	5:30pm – 7:00pm
Tuesday, June 12	7:00am – 5:00pm
Wednesday, June 13	7:00am – 12:00pm
Thursday, June 14	7:00am – 3:30pm

CYBER CAFÉ

The Cyber Café is located within the Exhibit area and can be accessed during exhibition hours.

CONFERENCE EVALUATION

The 2018 conference evaluation will be available in electronic format only.

Please visit naaccr2018.org to complete your evaluation. All delegates will be emailed reminders with a link to the evaluation form after the conference.

MOBILE APP DIRECTIONS



1. Visit eventmobi.com/app/naaccr2018
2. Tap the "Get The App" button
3. The app will automatically download from your app store and launch the event!

BRIDGING THE PATH TO THE FUTURE OF CANCER SURVEILLANCE

The 2018 conference will provide attendees with the opportunity to learn from national experts in cancer surveillance, cancer registry operations, and cancer research. Sessions will explore the new era in cancer surveillance from multiple perspectives in North America.



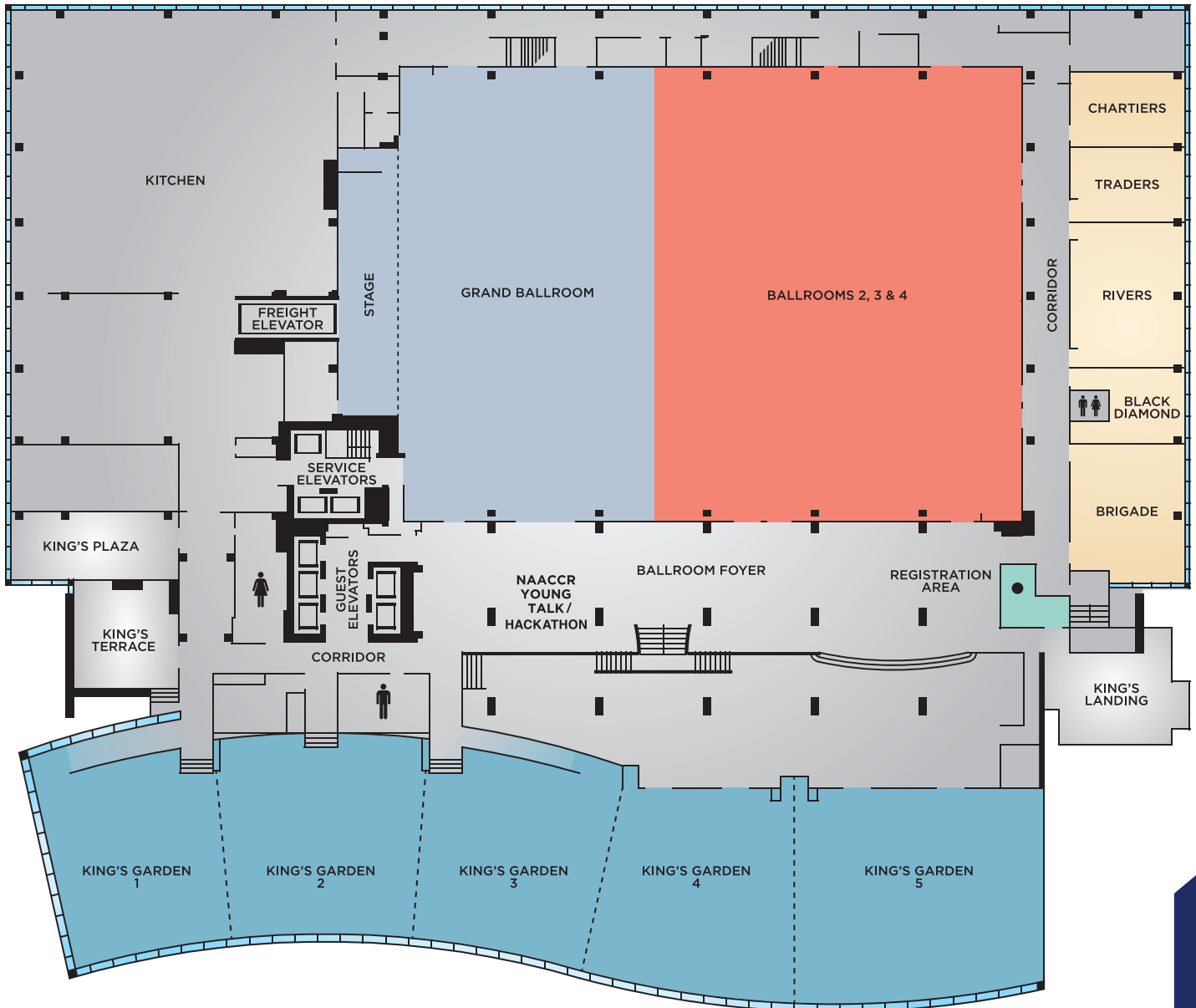

WYNDHAM GRAND
PITTSBURGH DOWNTOWN

BALLROOM LEVEL

- Plenary Sessions & Concurrent Sessions
- Exhibits & Posters
- Registration
- Concurrent Sessions + Pre Conference

SATURDAY JUNE 9 — MONDAY, JUNE 11

Daily: Sat to Mon 8:30am - 4:30pm	Offsite (Downtown Pittsburgh)	Cancer Informatics Hackathon <i>Presented by The North American Association of Central Cancer Registries.</i>	WORKSHOP
---	-------------------------------------	---	-----------------

SATURDAY, JUNE 9

8:30am - 5:30pm	King's Garden 5	SEER*Stat Basic Software Training SEER*Stat Basic Training covers case listing, frequency, and rate sessions. Joinpoint regression software and an introduction to Delay-Adjustment are also included. This course also includes a basic overview of age-adjustment and some key analytic fields.	WORKSHOP
-----------------	-----------------	---	-----------------

SUNDAY, JUNE 10

8:00am - 5:00pm	King's Garden 1	Board of Directors Meeting	MEETING
8:30am - 5:30pm	King's Garden 3	Advanced SEER*Stat Software Training SEER*Stat Advanced Topics cover survival, limited-duration prevalence, multiple primary analysis, and left-truncated life tables analysis using SEER*Stat.	WORKSHOP
9:00am - 2:00pm	King's Garden 4	Geocoding and Updates to the NAACCR Geocoder The Geocoding Operations course is a practical course designed to help registries improve their geocoding operations. This course will provide an overview of how geocoding works, outline pre- and post-geocoding processes, and detail recent changes with the NAACCR Geocoding. Special attention will be made to issues with geocoding quality and new features of the NAACCR Geocoder: MicroMatch Status, Penalty Score, Minimum Match Score, Exhaustive Search Function, and Interactive Geocoding Interface. Participants may upload registry data to the NAACCR geocoder prior to the course or use a non-confidential data set.	WORKSHOP
9:00am - 5:00pm	King's Garden 5	SEER Quality Improvement Experts Meeting (Invitation Only)	MEETING
1:00pm - 5:00pm	King's Garden 2	Match*Pro Training: Navigating the NEW Linkage Software This course will provide instruction on the use of Match*Pro, a new linkage software developed by IMS, Inc. Attendees will learn about basic linkage concepts, receive instruction on Match*Pro software functionality, and have the opportunity to perform test linkages and explore the system capabilities. This course is highly recommended for participants in the Virtual Pooled Registry (VPR). Match*Pro will be the software used for these linkages.	WORKSHOP

Grant Information



This program is supported in part by NCI Contract Number HHSN261201400004I from the National Cancer Institute and CDC Cooperative Agreement Number 5U58DP004917 from the Centers for Disease Control and Prevention. Its contents are solely the responsibility of the authors and do not necessarily represent the official views of the National Cancer Institute or the Centers for Disease Control and Prevention. Without their support, this scientific conference would not be possible.

PRE CONFERENCE

MONDAY, JUNE 11

8:00am - 5:00pm	NAACCR Committee and Partner Meetings Rooms are available for Steering Committees as well as work groups, task force groups, and subcommittee meetings that fall under each Steering Committee.		MEETINGS
8:00am - 5:00pm	King's Garden 2	CDC / NPCR Informatics Training (Invitation Only)	TRAINING
12:00pm - 7:00pm	Ballroom Foyer	NAACCR Annual Conference Registration and Check In	
2:00pm - 3:00pm	King's Garden 3	Communications Steering Committee Meeting	
2:00pm - 4:00pm	King's Garden 1	Standardization and Registry Development Steering Committee Meeting	
3:00pm - 4:00pm	King's Garden 4	Research and Data Use Steering Committee Meeting (All Attendees Invited)	
5:00pm - 6:30pm	Ballroom Foyer	Hackathon Presentations and Judging Prior to the Annual Conference NAACCR hosted a Hackathon in Downtown Pittsburgh. The competing teams will present their projects and results for judging. Join us for this truly unique event.	
5:30pm - 7:00pm	Ballroom 2, 3, 4	NAACCR Exhibitor Showcase and Poster Pre-Viewing All conference attendees are encouraged to attend the Exhibitor and Poster Pre-Viewing. Catch up with colleagues to meet and have a small bite to eat before you head out for the evening.	



6:30am - 8:00am	Ballroom 2, 3, 4	Breakfast
7:00am - 5:00pm	Ballroom Foyer	Conference Registration and Check In
7:00am - 5:00pm	Ballroom 2, 3, 4	Exhibit Hall Open and Poster Viewing
8:00am - 8:30am	Grand Ballroom	Opening Ceremonies and 2018 Program Chair Recognition
8:30am - 9:00am	Grand Ballroom	Keynote Speaker: Matt Jones "Cancer Registry is a Marathon": Matt will provide winning strategies for cancer surveillance field professionals for personal and professional success. He will share his against all odds story of conquering cancer three times, relearning how to walk and completing a marathon. He will leave the audience inspired, encouraged, and motivated for upcoming challenges.
9:00am - 10:00am	Plenary Session 1	
Bridge to the Future <i>Moderators:</i> <i>Wendy Aldinger & Sharon Winters</i>	Grand Ballroom	9:00 am - 9:20am 1PL1 Advances in Precision Medicine and Immunotherapy: What Cancer Registries Need to Know About Advances in Oncology <i>Dr. Jonathan C. Silverstein</i> <i>University of Pittsburgh School of Medicine</i>
		9:20am - 9:40am 1PL2 CAR-T Therapy and Other Advances in Immunotherapy <i>Dr. Kathleen Dorritie, University of Pittsburgh, Department of Medicine/Division of Hematology-Oncology</i>
		9:40am - 9:50am Q & A
		9:50am - 10:00am 2018 Presentation of the NAACCR Membership Recognition Awards
10:00am - 10:30am	Ballroom 2, 3, 4	Break, Exhibit and Poster Viewing
10:05am - 10:25am	Ballroom Foyer	NYT1 NAACCR YOUNG TALK Doing More With Less: Medicaid Administrative Claiming <i>L Giljahn, Ohio Department of Health, Columbus, OH, United States</i>
10:30am - 12:00pm	Concurrent Session 1	
A Epidemiology I <i>Moderator:</i> <i>Heather Zimmerman</i>	King's Garden 5	1A1 Development and Refinement of Recurrence Identification at a Population Level Using Routine Healthcare Datasets <i>J Charnock, Macmillan Cancer Support, London, Great Britain, Public Health England, London, Great Britain</i>
		1A2 The Epidemiology of Lung Cancer in Israel 1990 - 2014 <i>B Silverman, Israel National Cancer Registry, Israel Ministry of Health, Tel HaShomer, Israel</i>
		1A3 Factors Associated with Primary Tumor Resection in Stage IV Colon Cancer Patients: A SEER Patterns of Care Analysis <i>M Charlton, University of Iowa, Iowa City, IA, United States, Iowa Cancer Registry, Iowa City, IA, United States</i>
		1A4 Wait Time to Surgery and Survival Among Colorectal and Lung Cancer Patients in Ontario <i>T Navaneelan, Cancer Care Ontario, Toronto, ON, Canada</i>
		1A5 Treatment-Related Tools for Cancer Surveillance and Research: The Observational Research in Oncology Toolbox and SEER*Rx <i>D Rivera, National Cancer Institute, Rockville, MD, United States</i>

DAY 1 PROGRAM

10:30am - 12:00pm		Concurrent Session 1 Continued	
B Survival Studies <i>Moderator:</i> <i>Paulo Pinheiro</i>	King's Garden 4	1B1	Survival Among Native American Adolescent and Young Adult Cancer Patients in California <i>C Morris, UC Davis, Sacramento, CA, United States</i>
		1B2	Re-Evaluating Cancer Survival Trends Among Adolescents and Young Adults in the United States <i>L Liu, Los Angeles Cancer Surveillance Program, University of Southern California, Los Angeles, CA, United States</i>
		1B3	Ethnic Disparities in Melanoma Diagnosis and Survival: The Effects of Socioeconomic Status and Health Insurance Coverage <i>A Anderson-Mellies, University of Colorado Cancer Center, Aurora, CO, United States</i>
		1B4	Cancer Incidence, by Stage, in Canada <i>S Bryan, Statistics Canada, Ottawa, ON, Canada</i>
C The Long and Winding Road: Natural Language Processing <i>Moderator:</i> <i>Kyle Ziegler</i>	King's Garden 3	1C1	Uncertainty Quantification: Characterizing the Sources of Error in Automated Information Extraction from Pathology Reports <i>B McMahon, Los Alamos National Laboratory, Los Alamos, NM, United States</i>
		1C2	Combining Machine Learning and Uncertainty Quantification (UQ) to Develop Triage Rules to Partially Automate Registry Workflow <i>N Hengartner, Los Alamos National Laboratory, Los Alamos, NM, United States</i>
		1C3	DeepPhe - A Natural Language Processing System for Extracting Cancer Phenotypes from Clinical Records <i>G Savova, Boston Children's Hospital, Boston, MA, United States, Harvard Medical School, Boston, MA, United States</i>
		1C4	Capturing High-Resolution Temporal Cancer Phenotypes using DeepPhe <i>H Hochheiser, University of Pittsburgh, Pittsburgh, PA, United States</i>
		1C5	A Comprehensive Ontology of Hematology/Oncology Treatment Regimens <i>J Warner, HemOnc.org LLC, Lexington, MA, United States, Vanderbilt University Medical Center, Nashville, TN, United States, Vanderbilt University, Nashville, TN, United States</i>
D Finding Home: Advances in Residential History Data <i>Moderator:</i> <i>Recinda Sherman</i>	King's Garden 2	1D1	Integration of Individual Residential Histories into Cancer Research: An Overview <i>F Boscoe, New York State Cancer Registry, Albany, NY, United States</i>
		1D2	Use of Residential Histories in Exposure Reconstruction and Space-Time Cancer Clustering <i>G Jacquez, University at Buffalo, Buffalo, NY, United States</i>
		1D3	Progress Toward a Life-Course Perspective in Cancer Surveillance Research: Incorporating Residential Histories into Population-Based Cancer Registries Through Linkages with Public Records <i>A Stroup, Rutgers Cancer Institute of New Jersey, New Brunswick, NJ, United States, New Jersey State Cancer Registry, New Jersey Department of Health, Trenton, NJ, United States, Rutgers School of Public Health, Piscataway, NJ, United States</i>
		1D4	The Use of Residential Histories in Geospatial Research of Cancer: The Multiethnic Cohort Study <i>I Cheng, University of California, San Francisco, San Francisco, CA, United States</i>
		1D5	NCI Activities to Facilitate Residential History Research <i>Z Tatalovich, National Cancer Institute, Rockville, MD, United States</i>

10:30am - 12:00pm		Concurrent Session 1 Continued	
<div>E</div> <div>National Quality Control Initiatives</div> <div>Moderator: Stephanie Hill</div>	Grand Ballroom	1E1	Setting the Standard: NPCR and SEER Join Forces to Establish Data Quality Benchmarks <i>S Negoita, National Cancer Institute, Rockville, MD, United States</i>
		1E2	2017 National Program of Cancer Registries Data Quality Evaluation <i>S Manson, Centers for Disease Control and Prevention, Atlanta, GA, United States</i>
		1E3	The Data Quality Pre-Evaluation Framework & Approach to SEER-Wide Quality Audit Plan: Operational Results from Two Pilot Studies <i>D Dilts, Dilts+Partners, LLC, Nashville, TN, United States</i>
		1E4	SEER Quality Audit Plan: Proactive Quality Audit Plan Pilot Study <i>C Groves, Westat, Rockville, MD, United States</i>
		1E5	Reactive Quality Audit Pilot and Results: Quality Assurance Strategies for Cancer Surveillance <i>R Ehrenkranz, National Cancer Institute, Rockville, MD, United States</i>
<div>F</div> <div>Student Session I</div> <div>Moderator: Jeannette Jackson-Thompson</div>	King's Garden 1	1F15	Molecular Characterization of the Mortality Disparity in Tobacco-Associated Appalachian HNSCC <i>B Papenberg, West Virginia University, Morgantown, WV, United States</i>
		1F25	The Prognostic Value of Negative Lymph Node Count and Lymph Nodes Ratio in Male Breast Cancer <i>K Elhusseiny, Faculty of Medicine, Al-Azhar University, Cairo, Egypt</i>
		1F35	Nonclinical Factors Associated with Head and Neck Cancer Survivorship Among Patients with Metastatic Disease <i>N Osazuwa-Peters, Saint Louis University, Saint Louis/MO, United States</i>
		1F45	Improved Cancer Reporting Efficiency and Reduced Paper Waste: Lessons Learned from an Electronic Reporting Portal Recruitment Effort <i>E Stewart, University of California, Berkeley, Berkeley, CA, United States</i>
12:00pm - 1:30pm		Lunch on Your Own	
12:00pm - 1:30pm		Brigade	Medullary Thyroid Carcinoma Study Luncheon Sponsor: United BioSource Corporation (Invitation Only)
1:30pm - 3:00pm		Plenary Session 2	
<div>A Clear Path to the Legal Side</div> <div>Moderators: Antoinette Stroup & Chuck Wiggins</div>	Grand Ballroom	1:30pm - 1:55pm	2PL1 Establish and Use Legal Authority to Achieve Goals for Cancer Registration: A State Experience <i>Dr. Xiaocheng Wu, Louisiana Tumor Registry</i>
		1:55pm - 2:20pm	2PL2 Changing Laws to Collect E-Path in California <i>Dr. Dennis Deapen, Los Angeles Cancer Surveillance Program</i>
		2:20pm - 2:45pm	2PL3 Use of a Central IRB for Minimal Risk Study Reviews <i>Mr. Steve Friedman, MHSA, FAC-P/PM III, National Cancer Institute</i>
		2:45pm - 3:00pm	Q & A
3:00pm - 3:30pm		Ballroom 2, 3, 4 Break, Exhibit and Poster Viewing	
3:05pm - 3:25pm		Ballroom Foyer NYT2 NAACCR YOUNG TALK Automated Case Identification and Coding at the California Cancer Registry <i>J Patrick, Health Language Analytics Global, Sydney, NSW, Australia</i>	

DAY 1 PROGRAM

3:30pm - 5:00pm			Concurrent Session 2
A Epidemiology II Moderator: Frank Boscoe	Grand Ballroom	2A1	Trends in Premature Cancer Mortality in the USA by Race/Ethnicity and County-Level Income Quintile <i>D Withrow, Radiation Epidemiology Branch, National Cancer Institute, Rockville, MD, United States</i>
		2A2	A Preliminary Assessment of Cancer Trends Using Data from NPCR-CSS <i>R Wilson, CDC, Cancer Surveillance Branch, Atlanta, GA, United States</i>
		2A3	Incident Cancers Among Participants of the Alaska EARTH Study, and Associations with Known Cancer Risk Factors <i>S Nash, Alaska Native Tribal Health Consortium, Anchorage, AK, United States</i>
		2A4	Trends in Colorectal Cancer Incidence Among Younger Adults - Disparities by Subsite, Age, Sex, Race, Ethnicity, and Stage <i>A Crosbie, New Jersey Department of Health, Cancer Epidemiology Services, Trenton, NJ, United States</i>
B Global Perspectives on Survival Moderator: Chris Johnson	King's Garden 5	2B1	A Comparison of Relative Survival with Cause-Specific Survival Using Updated Methods in the SEER Program <i>G Forjaz de Lacerda, Division of Cancer Control and Population Sciences, National Cancer Institute, Rockville, MD, United States</i>
		2B2	Comprehensive Cancer Survival Comparisons Across Seven Countries, 1995-2014: The ICBP SURVMARK2 Project <i>M Arnold, International Agency For Research On Cancer, Lyon, France</i>
		2B3	Women's Cancers: Prospects for a World-Wide High-Resolution Study <i>C Allemani, London School of Hygiene and Tropical Medicine, London, Great Britain</i>
		2B4	The American Cancer Society's Cancer Prevention Study-3: A Large-Scale Nationwide Prospective Cohort <i>A Deka, American Cancer Society, Atlanta, GA, United States</i>
C On the Path to XML Moderator: Rich Pinder	King's Garden 4	2C1	The Path to Full XML Data Exchange Standard Implementation <i>I Hands, Kentucky Cancer Registry, Lexington, KY, United States</i>
		2C2	SAS and NAACCR XML Data Files <i>F Depry, Information Management Services, Inc., Calverton, MD, United States</i>
		2C3	Building an Ancillary System for Cancer Registries from SDC CAP Templates <i>J Seiffert, CyberData Technologies, Herndon, VA, United States</i>
D Bridging the Timeliness Gap Moderator: Christina Lisella	King's Garden 3	2D1	The Real-World Story of Real-Time Reporting: Findings from the NAACCR Assessment of Central Cancer Registry Timeliness and Reporting Task Force <i>A Stroup, Rutgers Cancer Institute of New Jersey, New Brunswick, NJ, United States, New Jersey State Cancer Registry, New Jersey Department of Health, Trenton, NJ, United States, Department of Epidemiology, Rutgers School of Public Health, Piscataway, NJ, United States</i>
		2D2	Childhood Cancer Data Collection: A Trend Analysis of Timeliness from NPCR-ECC (October 2012 - October 2017 Submissions) <i>K Zhang, ICF, Fairfax, VA, United States</i>
		2D3	Timeliness of Cancer Reporting at the Maryland Cancer Registry <i>W Ross, Westat, Rockville, MD, United States</i>
		2D4	Early Case Capture of Pediatric and Young Adult Cancers: A Comprehensive Examination of the Kentucky Cancer Registry's Early Case Capture Strategies <i>E Lyan, Kentucky Cancer Registry, University of Kentucky, Lexington, KY, United States</i>

3:30pm - 5:00pm	Concurrent Session 2 Continued	
E Cancer Disparities Tools: SEER HD*Calc Tool <i>Moderator:</i> <i>Recinda Sherman</i>	King's Garden 2	2E1 Social Value Judgements in SES Disparities Assessment Using HD*Calc - Colorectal Cancer Mortality <i>D Lewis, National Cancer Institute, Bethesda, MD, United States</i>
		2E2 Using HD*Calc with Complex Survey Data <i>M Yu, National Cancer Institute, Bethesda, MD, United States</i>
		2E3 Demonstration of HD*Calc Using Examples of Mortality Data and Complex Survey Data <i>S Scoppa, IMS, Inc., Calverton, MD, United States</i>
F Student Session II <i>Moderator:</i> <i>Castine Clerkin</i>	King's Garden 1	2F1S Changes in Health-Related Quality of Life in Older Women after Diagnosis with Gynecological Cancer: A Population-Based Analysis Using the Surveillance, Epidemiology, and End Results Medicare Health Outcomes Survey <i>A Klapheke, University of California Davis, Davis, CA, United States</i>
		2F2S The Association Between Lifetime Screening for Cancer and Receipt of Annual Flu Vaccination: Are There Reinforcing Effects of Prevention Seeking? <i>I Watson, University of North Dakota - School of Medicine and Health and Sciences, Grand Forks, ND, United States</i>
		2F3S Disparities in Systemic Therapy Use in Advanced-Stage Non-Small Cell Lung Cancer (NSCLC) by Source of Health Insurance <i>F Maguire, University of California Davis Health, Institute for Population Health Improvement, Sacramento, CA, United States</i>
		2F4S Cancer Survivor Prevalence of Hepatobiliary Cancers in the SEER Population, 1975-2014 <i>A Ayers, George Washington University, Washington, DC, United States</i>
5:30pm - 6:30pm <i>Moderators:</i> <i>Gary Levin & Melanie Williams</i>	King's Garden 5	Birds of a Feather Open Discussion Forum "Doing More with Less" Join us for this lively discussion on the challenges and potential solutions presented.
7:00pm - 9:30pm	Grand Ballroom	2018 Opening Reception <i>Doors open at 7:00pm</i> All conference attendees are encouraged to attend the 2018 Opening Reception. This is a great opportunity to meet with friends and colleagues. You will also be sure to meet new acquaintances to expand your professional network. We will serve a great choice of delicious appetizers and a DJ will provide the right dance beats. A cash bar will also be available.
9:30pm	Day One Ends	

DAY 2 PROGRAM

6:30am - 8:00am	Ballroom 2, 3, 4	Breakfast
7:00pm - 12:00pm	Ballroom 2, 3, 4	Exhibit Hall Open and Poster Viewing
7:30am - 11:45am	Ballroom Foyer	Conference Registration and Check In
8:15am - 8:45am	Grand Ballroom	NAACCR Business Meeting (Open to All) All conference delegates are invited to attend the 2018 NAACCR Business Meeting. Voting Delegates from their respective organizations are required to attend the NAACCR Business Meeting.
9:00am - 10:30am	Concurrent Session 3	
A Epidemiology III Moderator: Angela Meisner	King's Garden 5	3A1 The Devil's in the Data Details: National Program of Cancer Registries (NPCR) Component 2 Public Health Surveillance Pilot Projects on Prognostic Factors, Breast and Cervical Cancer Screening, and CIN III <i>P Pordell, Centers for Disease Control and Prevention, Atlanta, GA, United States</i>
		3A2 Racial Disparities in Uterine Corpus Cancer Survival in the United States by Age and Stage <i>K Miller, American Cancer Society, Inc., Atlanta, GA, United States</i>
		3A3 Monitoring the Impact of HPV Vaccine Using Tissues from Central Cancer Registries (HPV Typing 2 Study) <i>B Hallowell, Centers for Disease Control and Prevention, Atlanta, GA, United States</i>
		3A4 Ovarian Cancer Incidence and Survival in the United States by Subtype, Age, and Race/Ethnicity <i>L Torre, American Cancer Society, Atlanta, GA, United States</i>
B Environmental & Occupational Epidemiology Moderator: Mary Lewis	King's Garden 4	3B1 Investigation of a Possible Link Between Pollution from Military Facilities and Cancer on St. Lawrence Island, Alaska <i>D O'Brien, Alaska Cancer Registry, Anchorage, AK, United States</i>
		3B2 Did 9/11 Cause Cancer? The Role of the State Cancer Registry in Answering the Question <i>A Kahn, New York State Cancer Registry, Albany, NY, United States</i>
		3B3 Cancer Risk Among Florida Firefighters <i>D Lee, Department of Public Health Sciences, University of Miami Miller School of Medicine, Miami, FL, United States, Sylvester Comprehensive Cancer Center, University of Miami Miller School of Medicine, Miami, FL, United States, Florida Cancer Data System, University of Miami Miller School of Medicine, Miami, FL, United States</i>
		3B4 Malignant Mesothelioma Age-Adjusted Incidence Rates and Trends from the New Jersey State Cancer Registry (NJSCR) and the Surveillance, Epidemiology, and End Results (SEER) registries, 1992 - 2014 <i>P Agovino, New Jersey Department of Health, Trenton, NJ, United States</i>



9:00am - 10:30am	Concurrent Session 3 Continued	
C Virtual Pooled Registry Cancer Linkage System <i>Moderator:</i> <i>Recinda Sherman</i>	King's Garden 3	3C1 Virtual Pooled Registry Cancer Linkage System: Building a Bridge to Streamlined IRB/Registry Application Processes for Multi-Registry Linkages <i>C Clerkin, NAACCR, Springfield, IL, United States</i>
		3C2 Web Portal for Virtual Pooled Registry Cancer Registry Linkage System (VPR-CLS) <i>D Green, IMS Inc., Calverton, MD, United States</i>
		3C3 Using the Virtual Pooled Registry Cancer Linkage System for Interstate Deduplication, Results from Second Pilot Test <i>C Johnson, Cancer Data Registry of Idaho, Boise, ID, United States</i>
		3C4 Linkage of the U.S. Radiologic Technologists (USRT) Cohort with Nationwide NAACCR Cancer Registries Methods and Preliminary Results <i>A Landgren, Division of Cancer Epidemiology and Genetics, National Cancer Institute (DCEG, NCI), Rockville, MD, United States</i>
D Improving Registry Operations <i>Moderator:</i> <i>Sharon Winters</i>	Grand Ballroom	3D1 Recruitment and Retention: A Challenge for Central Cancer Registries <i>F Ross, Kentucky Cancer Registry, Lexington, KY, United States</i>
		3D2 Will Data Quality Suffer without Visual Editing Review of Resolve Patient Set Tasks? <i>N Lozon, Wayne State University, Detroit, MI, United States, Karmanos Cancer Institute, Detroit, MI, United States</i>
		3D3 NAACCR Pathology Laboratory Electronic Reporting Volume 5, Version 5 <i>J Mazuryk, Cancer Care Ontario, Toronto, ON, Canada</i>
		3D4 Setting the Stage for Change: Upgrading the Physician Cancer Case Reporting Application in New York <i>A Austin, NYS Cancer Registry, Albany, NY, United States</i>
E Breast Cancer <i>Moderator:</i> <i>Melanie Williams</i>	King's Garden 2	3E1 The Association of Breast Cancer Subtypes, Guideline-Concordant Treatment and Survival Among Patients with Stage I-III Disease <i>M Hsieh, Louisiana Tumor Registry, School of Public Health, LSU Health Sciences Center, New Orleans, LA, United States</i>
		3E2 Triple-Negative Breast Cancer Incidence Across the United States: Correlations with Area-Level SES and Behaviors <i>J Moss, National Cancer Institute, Bethesda, MD, United States</i>
		3E3 Breast Cancer Subtypes Defined by Joint Hormone Receptor and HER2 Status Among U.S. Cases with African Ancestry by Place of Birth <i>H Sung, American Cancer Society, Atlanta, GA, United States</i>
		3E4 Examining Subsequent Occurrence and Outcomes of Estrogen-Related Cancers (Breast and Thyroid) in Missouri Women <i>C Schmaltz, Health Management and Informatics, University of Missouri, Columbia, MO, United States, Missouri Cancer Registry and Research Center, University of Missouri, Columbia, MO, United States</i>
10:30am - 11:00am	Ballroom 2, 3, 4	Break, Exhibit and Poster Viewing

DAY 2 PROGRAM

10:35am - 10:55am	Ballroom Foyer	NYT3 NAACCR YOUNG TALK Automated Extraction and Assignment of TNM Stage to Support Cancer Case Consolidation <i>M Carter, Utah Cancer Registry, University of Utah, Salt Lake City, UT, United States</i>	
11:00am - 1:00pm	Plenary Session 3		
New Paths to New Data and New Sources <i>Moderators: Lynne Penberthy & Vicki Benard</i>	Grand Ballroom	11:00am - 11:25am	3PL1 Using Data from EMR's: The Rise of Nationwide Networks <i>Jitin Asnaani, BS, MBA, CommonWell</i>
		11:25am - 11:50pm	3PL2 New Data and Approaches to Learn and Capture Recurrence Information <i>Dr. Angela Mariotto, National Cancer Institute</i>
		11:50pm - 12:15pm	3PL3 Using Structured Data Capture to Enhance Cancer Surveillance Data Collection <i>Sandy Jones, MDE, Centers for Disease Control and Prevention</i>
		12:15pm - 12:30pm	Q & A
		12:30pm - 1:00pm	Presentation of the Calum S. Muir Award, Constance Percy Award for Distinguished Service, Outgoing NAACCR Board Member Awards, Board Resolutions and NAACCR Certification
1:00pm - 2:00pm	Lunch On Your Own		
2:00pm - 6:30pm	Scheduled Meetings		
	King's Garden 3	2:00pm - 3:30pm	Professional Development Steering Committee Meeting
	King's Garden 4	4:00pm - 5:30pm	XML Data Exchange Work Group Meeting
	Participants will meet Golden Triangle Bike Company in the Point State Park directly across from the Wyndham Grand Hotel at 3:20pm.	4:00pm	Explore Pittsburgh Bike Ride Tour (pre-registration was required) The Explore Pittsburgh Bike Tour connects riders to the riverfront trails while highlighting Pittsburgh's current developments as well as its history. Knowledgeable guides will provide them with a unique perspective of the City of Champyinz! They run an easy and enjoyable tour pace suitable for everyone to enjoy. The saddle time will be roughly 2 hours with stops along the way.
	King's Garden 4	5:30pm - 6:30pm	XML EDITS Work Group Meeting
6:30pm	Day Two Ends		

6:30am - 8:00am	Ballroom 2, 3, 4	Breakfast	
6:30am - 7:30am	Offsite	Free Fun Run / Walk NAACCR encourages all attendees to take advantage of the NAACCR walk/run. It is estimated that over half of cancer cases can be prevented by lifestyle changes such as exercise, the limitation of tobacco use, and improved nutrition. Meet in the hotel lobby to enjoy a nice walk or jog to start your day off right! FREE	
7:00am - 11:30am	Ballroom Foyer	Conference Registration and Check In	
7:00am - 1:30pm	Ballroom 2, 3, 4	Exhibit Hall Open and Poster Viewing	
8:30am - 10:00am	Plenary Session 4		
Cancer Surveillance Data for Cancer Control and Clinical Outcome Improvement <i>Moderators: Randi Rycroft & Thomas C. Tucker</i>	Grand Ballroom	8:30am - 8:50am	4PL1 American Cancer Society CAN; How ACS CAN Uses Cancer Surveillance Data and Data Need to Promote Cancer Prevention and Control (including new legislations and increasing fund for cancer research and cancer registry) in the United States <i>Catherine McMahon, MPH, American Cancer Society Cancer Action Network, Inc.</i>
		8:50am - 9:10am	4PL2 Using Central Cancer Registries to Document the Impact of Novel Therapies in a Population-Based Setting <i>Dr. Chuck Wiggins, New Mexico Tumor Registry</i>
		9:10am - 9:30am	4PL3 Estimating the Current and Future Burden of Cancer in Canada: Identifying Opportunities for Prevention in the ComPARE Project <i>Dr. Darren R. Brenner, University of Calgary, Oncology and Community Health Science</i>
		9:30am - 9:50am	4PL4 Patient Reported Outcomes in Canada <i>Dr. Craig Earle, Canadian Partnership Against Cancer</i>
		9:50am - 10:00am	Q & A
		10:00am - 10:30am	Ballroom 2, 3, 4



DAY 3 PROGRAM

10:30am - 12:00pm		Concurrent Session 4	
A Epidemiology IV Moderator: Jim Hofferkamp	King's Garden 5	4A1	Cancer Prevalence: the Benefits of a Centralised National Registry in Accurately Identifying Those Living with and Beyond Cancer <i>J Charnock, Macmillan Cancer Support, London, Great Britain, Public Health England, London, Great Britain</i>
		4A2	Are Missed Cases Contributing to the Decline in Prostate Cancer Incidence? <i>K Cronin, National Cancer Institute, Bethesda, MD, United States</i>
		4A3	Prostate Cancer Incidence, Mortality and Prostate-Specific Antigen (PSA)-Based Screening Rates in Maine in Relation to Changes in U.S. Preventive Services Task Force (USPSTF) Prostate Screening Recommendations <i>D Yob, University of Southern Maine, Portland, ME, United States</i>
		4A4	Application of CiNA Data: Geographic Patterns in Lung Cancer Incidence <i>D Lewis, National Cancer Institute, Bethesda, MD, United States</i>
B Tools for Cancer Surveillance Moderator: Lori Koch	King's Garden 4	4B1	Using SEER Data to Develop Synthetic Cancer Trajectories that Enable Cancer Research <i>S Michalak, Los Alamos National Laboratory, Los Alamos, NM, United States</i>
		4B2	Advancing Cancer Surveillance in Less Resourced Settings Through Adaptation Of Seer Analysis Tools <i>G Forjaz de Lacerda, Division of Cancer Control and Population Sciences, National Cancer Institute, Rockville, MD, United States</i>
		4B3	Bridging The Path to the Future Using A New Data Item Consolidation Tool: Registry Plus Consolidation Rules Editor <i>M Esterly, Booz Allen Hamilton, McLean, VA, United States</i>
		4B4	Implementing Telemetry Recording in Registry Software to Provide On-Going Performance Feedback <i>J Golabek, Artificial Intelligence in Medicine, Toronto, ON, Canada</i>
C Linkage Tools and Deduplication Moderator: Randi Rycroft	Grand Ballroom	4C1	Evaluating Record Linkage Software Using Representative Synthetic Datasets <i>B Liu, National Cancer Institute, Bethesda, MD, United States</i>
		4C2	An Introduction to Fastlink for Probabilistic Record Linkage <i>A Alexandersson, Florida Cancer Data System, University of Miami, Miami, FL, United States</i>
		4C3	Linkage Adjudication Practices and Perspectives: a Quality Study in SEER Registries <i>V Petkov, National Cancer Institute, Rockville, MD, United States</i>
		4C4	Feasibility Of Deduplicating Deidentified Data Submitted To CDC's National Program Of Cancer Registries <i>S Van Heest, CDC, Atlanta, GA, United States</i>
D Geospatial & Community Clusters Moderator: Chuck Wiggins	King's Garden 3	4D1	Cluster Bluster: Cancer Tends to Cluster Less than Other Diseases and Conditions <i>F Boscoe, New York State Cancer Registry, Albany, NY, United States</i>
		4D2	Cancer Cluster Investigations The New Mexico Experience <i>A Meisner, New Mexico Tumor Registry, Albuquerque, NM, United States</i>
		4D3	Investigation of Ocular Melanoma An Aggressive Form of Rare Tumor Diagnosed Clinically <i>C Rao, North Carolina Central Cancer Registry, Raleigh, NC, United States</i>
		4D4	Availability of Cancer Treatment in Montana: Where are the Gaps? <i>H Zimmerman, Montana Department of Public Health and Human Services, Helena, MT, United States</i>

10:30am - 12:00pm	Concurrent Session 4 Continued	
E Biomarkers and Tissue Repositories <i>Moderator:</i> <i>Susan Gershman</i>	King's Garden 2	4E1 SEER Virtual Tissue Repository Initiative: Current Status and Future Goals <i>V Petkov, National Cancer Institute, Rockville, MD, United States</i>
		4E2 Requesting Diagnostic Tissue Specimens at the Registry Level <i>C Lefante, Louisiana Tumor Registry, New Orleans, LA, United States, Louisiana State University Health Sciences Center; School of Public Health, New Orleans, LA, United States</i>
		4E3 The Kentucky Cancer Registry: Our Journey Towards Precision Cancer Surveillance <i>E Durbin, Kentucky Cancer Registry, Lexington, KY, United States Markey Cancer Center/University of Kentucky, Lexington, KY, United States</i>
		4E4 Extract Breast Cancer Genetic Markers in Pathology Reports Using Natural Language Processing <i>G Chennupati, Los Alamos National Laboratory, Los Alamos, NM, United States</i>
F Bridge Session - Roberto Clemente <i>Moderator:</i> <i>Wendy Aldinger</i>	King's Garden 1	4F1 Augmenting Smoking History in Cancer Registry Data Through Health Administrative Claims Data <i>Q Chen, University of Kentucky, Lexington, KY, United States</i>
		4F2 Invasive Cancer Incidence Adjusted for Reporting Delay in the United States, 2000 - 2014 <i>SD Singh, CDC, Atlanta, GA, United States</i>
		4F3 Evaluation of Geocoding Procedures in the National Program of Cancer Registries <i>AM Lavery, Centers for Disease Control and Prevention, Atlanta, GA, United States</i>
		4F4 Overall and Specific Cancer Mortality Rates Among U.S. and Foreign-Born Persons; United States 2005-2015 <i>B Hallowell, Centers for Disease Control and Prevention, Atlanta, GA, United States</i>
12:00pm - 1:30pm	Lunch On Your Own, Exhibit and Poster Viewing	
1:30pm - 2:30pm	Ballroom 2, 3, 4	Exhibit Break Down and Poster Removal



DAY 3 PROGRAM

1:30pm - 3:00pm		Concurrent Session 5	
A Brain Cancer Moderator: Reda Wilson	King's Garden 5	5A1	Evaluating the Completeness of WHO Grade for Brain and Central Nervous System Tumors in the U.S., 2010 - 2014 <i>M Hsieh, Louisiana Tumor Registry/Epidemiology Program, School of Public Health, LSU Health Sciences Center, New Orleans, LA, United States</i>
		5A2	Sunshine, Lollipops and Rainbows: Moving Forward Optimistically with the Cooperation and Collaboration that Achieved Collection of CNS Biomarkers <i>C Kruchko, Central Brain Tumor Registry of the United States, Hinsdale, IL, United States</i>
		5A3	Trends in Malignant Brain and Central Nervous System Tumor Incidence by Subtype Among Children in the United States, 1998 - 2013 <i>D Withrow, Radiation Epidemiology Branch, National Cancer Institute, Rockville, MD, United States</i>
B Patient Reported Outcomes Moderator: Stephen Slack	Grand Ballroom	5B1	PROM (Patient Reported Outcome Measure) Survey Suggests Some Men with Prostate Cancer May Be Unaware of Their Diagnosis <i>P Stacey, Public Health England, London, Great Britain</i>
		5B2	Web Compared to Paper Survey Response Outcomes Among Individuals Diagnosed with Cancer: Assessing the Feasibility of Web Surveys for Obtaining Patient-Reported Outcomes <i>M Millar, Utah Cancer Registry, Salt Lake City, UT, United States, University of Utah Division of Epidemiology, Salt Lake City, UT, United States</i>
		5B3	Using Bi-Directional Reporting to Improve Clinical Care <i>R Rycroft, Colorado Central Cancer Registry, Denver, CO, United States</i>
		5B4	Cancer Survivor Perspectives on Providing Patient Reported Data to and Getting Information Back from Central Cancer Registries <i>T Smith, American Cancer Society, Atlanta, GA, United States</i>
C Linkage Applications Moderator: Castine Clerkin	King's Garden 4	5C1	Pilot Linkage of the Colorado Central Cancer Registry and the Colorado All Payer Claims Database <i>M Eguchi, University of Colorado Cancer Center, Denver, CO, United States</i>
		5C2	Linking Cancer Registries with Claims Data to Enable Community Oncology Reporting <i>C Fedorenko, HICOR, Fred Hutchinson Cancer Research Center, Seattle, WA, United States</i>
		5C3	Linking Big (Federal) Data to State Cancer Registry Data for a Post-Marketing Drug Safety Surveillance Study: Challenges and Lessons Learned <i>D Harris, RTI Health Solutions, Research Triangle Park, NC, United States</i>
		5C4	Investigating Disparities in Cancer by Linking the Canadian Cancer Registry to Survey and Administrative Databases: A Collaboration Between the Canadian Partnership Against Cancer and Statistics Canada <i>J Tung, Canadian Partnership Against Cancer, Toronto, ON, Canada</i>
D Data Visualization Moderator: David O'Brien	King's Garden 3	5D1	Not Just a Pretty Picture: The U.S. Cancer Statistics Data Visualization Tool <i>S Singh, CDC, Atlanta, GA, United States</i>
		5D2	On the Fly Analysis and Visualization of Cancer Data Using Interactive Business Intelligence Dashboard: The Puerto Rico Central Cancer Registry Experience <i>C Torres-Cintrón, Puerto Rico Central Cancer Registry, San Juan, Puerto Rico</i>
		5D3	Smart Mapping: Predominance of Cancer Incidence and Mortality and Proximity to National Cancer Institute (NCI)-Designated Cancer Centers <i>A Klapheke, Public Health Institute, Cancer Registry of Greater California, Sacramento, CA, United States</i>

1:30pm - 3:00pm	Concurrent Session 5 Continued	
E Melanoma Moderator: Hannah Weir	King's Garden 2	5E1 Keep Your Head Out of the Clouds: Comparing Cutaneous Head and Neck Melanomas Between a Mountainous and a Coastal Population <i>A Anderson-Mellies, University of Colorado Cancer Center, Aurora, CO, United States</i>
		5E2 Poor Prognosis for Thin Ulcerated Melanomas and Implications for a More Aggressive Approach to Treatment <i>M Hawkins, University of Colorado Cancer Center, University of Colorado, Aurora, CO, United States</i>
		5E3 Comparison of Characteristics, Treatment Patterns and Survival Outcomes of Primary GI Melanoma Cases to Cutaneous Melanoma and GI Carcinoma (SEER: 1973 - 2014) <i>A Kahl, University of Iowa, Iowa City, IA, United States, Iowa Cancer Registry, Iowa City, IA, United States</i>
		5E4 Melanoma Among Blacks in the United States <i>M Freeman, ORISE, Oak Ridge, TN, United States, CDC, Atlanta, GA, United States</i>
F Bridge Session - Rachel Carson Moderator: Lori Havener	King's Garden 1	5F1 Identify Cancer Misdiagnoses Faster by Utilizing IBM Watson Explorer, a Natural Language Processing Tool <i>M Induni, Public Health Institute, Cancer Registry of Greater California, Sacramento, CA, United States</i>
		5F2 A New Cancer Research Data Source: NPCR and SEER Public Use Database 2001 - 2014 <i>M O'Neil, Centers for Disease Control and Prevention, Atlanta, GA, United States</i>
		5F3 Tools for Data Analysis: Ohio's Public Health Information Warehouse <i>L Giljahn, Ohio Department of Health, Columbus, Ohio, United States</i>
3:00pm - 3:30pm	Ballroom Foyer	Break



DAY 3 PROGRAM

3:30pm - 5:30pm Plenary Session 5			
Bridge to the Future - The NAACCR Showcase <i>Moderators: Frank Boscoe & Antoinette Stroup</i>	Grand Ballroom	3:30pm - 3:50pm	Student Poster and Oral Awards
		3:50pm - 4:10pm	Late Breaker Updates
		4:10pm - 4:30pm	Presidential Update <i>Dr. Antoinette Stroup, NAACCR Board President</i>
		4:30pm - 4:50pm	Virtual Pooled Registry Update <i>Castine Clerkin, Program Manager of Virtual Pooled Registry, NAACCR, Inc.</i>
		4:40pm - 4:50pm	NAACCR Hackathon Results <i>Michelle Esterly, Hackathon Committee</i>
4:50pm - 5:15pm	Grand Ballroom	Closing Ceremonies	
5:15pm - 5:30pm	Grand Ballroom	Invitation to NAACCR 2019, Vancouver, British Columbia, Canada!	
5:30pm	2018 NAACCR Annual Conference Concludes		
5:30pm - 6:30pm	Ballroom Foyer	Closing Networking Opportunity Take advantage of this opportunity to wrap up the conference with colleagues and new connections before you depart. Refreshments and cash bar will be available.	



© Dave DiCello

PROGRAM AT A GLANCE



TIME	MONDAY, JUNE 11	TUESDAY, JUNE 12	WEDNESDAY, JUNE 13	THURSDAY, JUNE 14	TIME
6:30 am				NAACCR FREE FUN RUN / WALK Meet in Hotel Lobby: 6:30am - 7:30am	6:30 am
7:00					7:00
7:30		OPENING CEREMONIES Grand Ballroom: 8:00am - 8:30am KEYNOTE SPEECH Grand Ballroom: 8:30am - 9:00am	NAACCR BUSINESS MEETING Grand Ballroom: 8:15am - 8:45am		7:30
8:00	NAACCR COMMITTEE & PARTNER MEETINGS Various locations: 8:00am - 5:00pm			PLENARY SESSION 4 Cancer Surveillance Data for Cancer Control and Clinical Outcome Improvement Grand Ballroom: 8:30am - 10:00am	8:00
8:30		PLENARY SESSION 1: Bridge to the Future Grand Ballroom: 9:00am - 10:00am	CONCURRENT SESSION 3 Various Rooms: 9:00am - 10:30am		8:30
9:00	CDC / NPICR INFORMATICS TRAINING Various locations: 8:00am - 5:00pm	BREAK/POSTERS/EXHIBITS: 10:00am - 10:30am NAACCR YOUNG TALK 1: 10:05am - 10:25am	BREAK/POSTERS/EXHIBITS: 10:30am - 11:00am NAACCR YOUNG TALK 3: 10:35am - 10:55am	BREAK/POSTERS/EXHIBITS: 10:00am - 10:30am	9:00
9:30					9:30
10:00		BREAK/POSTERS/EXHIBITS: 10:00am - 10:30am NAACCR YOUNG TALK 1: 10:05am - 10:25am			10:00
10:30		CONCURRENT SESSION 1 Various Rooms: 10:30am - 12:00pm	NAACCR YOUNG TALK 3: 10:35am - 10:55am	CONCURRENT SESSION 4 Various Rooms: 10:30am - 12:00pm	10:30
11:00			PLENARY SESSION 3 New Paths to New Data and New Sources Grand Ballroom: 11:00am - 1:00pm		11:00
11:30					11:30
12:00 pm		LUNCH ON YOUR OWN POSTERS/EXHIBITS: 12:00pm - 1:30pm			12:00 pm
12:30				LUNCH ON YOUR OWN/POSTERS/EXHIBITS Ballroom 2, 3, 4: 12:00pm - 1:30pm	12:30
1:00					1:00
1:30					1:30
2:00	COMMUNICATIONS STEERING COMMITTEE King's Garden 3: 2:00pm - 3:00pm	PLENARY SESSION 2 A Clear Path to the Legal Side Grand Ballroom: 1:30pm - 3:00pm	PROFESSIONAL DEVELOPMENT STEERING COMMITTEE King's Garden 3: 2:00pm - 3:30pm	CONCURRENT SESSION 5 Various Rooms: 1:30pm - 3:00pm	2:00
2:30					2:30
3:00	STANDARDIZATION & REGISTRY DEVELOPMENT STEERING COMMITTEE King's Garden 1: 2:00pm - 4:00pm	BREAK/POSTERS/EXHIBITS: 3:00pm - 3:30pm NAACCR YOUNG TALK 2: 3:05pm - 3:25pm		BREAK: 3:00pm - 3:30pm	3:00
3:30			EXPLORE PITTSBURGH BIKE RIDE TOUR Meet at Point State Park, 4:00pm	PLENARY SESSION 5 Bridge to the Future - The NAACCR Showcase Grand Ballroom: 3:30pm - 5:30pm	3:30
4:00	RESEARCH & DATA USE STEERING COMMITTEE King's Garden 4: 3:00pm - 4:00pm	CONCURRENT SESSION 2 Various Rooms: 3:30pm - 5:00pm	XML DATA EXCHANGE WORK GROUP MTG Kind's Garden 4: 4:00pm - 5:30pm	CLOSING CEREMONIES: 4:50pm - 5:15pm	4:00
4:30					4:30
5:00					5:00
5:30	HACKATHON Presentations & Judging Ballroom Foyer: 5:00pm - 6:30pm	BIRDS OF A FEATHER OPEN DISCUSSION King's Garden 5: 5:30pm - 6:30pm	XML EDITS WORK GROUP MEETING King's Garden 4: 5:30pm - 6:30pm	INVITATION TO NAACCR 2019: 5:15pm - 5:30pm	5:30
6:00	Exhibitor Showcase and Poster Pre-Viewing Ballroom 2, 3, 4: 5:30pm - 7:00pm			CLOSING NETWORKING OPPORTUNITY Ballroom Foyer: 5:30pm - 6:30pm	6:00
6:30					6:30
7:00					7:00
7:30					7:30
8:00					8:00
8:30					8:30
9:00					9:00
9:30					9:30

Plenary Sessions

Concurrent Sessions

Committee Meetings

Other Sessions

Break/Lunch

Breaks: Ballroom 2, 3, 4