



**FIRST IN FLIGHT:
LAUNCHING A NEW ERA
IN CANCER SURVEILLANCE**



**NORTH AMERICAN ASSOCIATION OF
CENTRAL CANCER REGISTRIES**

**2015 NAACCR ANNUAL CONFERENCE
JUNE 13-18, 2015 | WESTIN CHARLOTTE**

**FINAL
PROGRAM**



EXHIBITORS & SPONSORS

CONFERENCE SPONSOR



NOVO NORDISK

100 College Road West
Princeton, NJ 08540
Tel: 215-390-1395
Contact: Dr. Kelly Davis of UBS
Email: kelly.davis@unitedbiosource.com

EXHIBITORS:



AMERICAN CANCER SOCIETY

250 Williams Street NW
Atlanta, GA 30303
Tel: 404-329-7992
Contact: Rebecca Siegel
Email: rebecca.siegel@cancer.org



ARTIFICIAL INTELLIGENCE IN MEDICINE INC.

2 Berkeley Street, Suite 403
Toronto, ON, M5A 2W3
Tel: 866-645-2224
Contact: Victor Brunka
Email: vbrunka@aim.ca



ELEKTA

400 Perimeter Center Terrace, Suite 50
Atlanta, GA 30346
Tel: 770-300-9725
Contact: Lori Minton
Email: Lori.Minton@Elekta.com

GRANT INFORMATION



This program is supported in part by NCI Grant Number R13CA196201 from the National Cancer Institute and CDC Cooperative Agreement Number 5U58DP004917 from the Centers for Disease Control and Prevention. Its contents are solely the responsibility of the authors and do not necessarily represent the official views of the National Cancer Institute or the Centers for Disease Control and Prevention.

FLATIRON

FLATIRON HEALTH

96 Spring Street, 8th floor
New York, NY 10012
Tel: 516-287-4207
Contact: Fiorella Bariani
Email: fiorella@flatiron.com

HEALTH LANGUAGE ANALYTICS

Suite 4, International Business Centre
2 Cornwallis Rd, Eveleigh,
NSW Australia. 2016
Tel: 61 2 8091 2690
Contact: Maryellen Galbally
Email: maiellen@iinet.net.au



ICF INTERNATIONAL

9300 Lee Highway
Fairfax, VA 22031
Tel: 703-251-8943
Contact: Sara Noll
Email: sarah.noll@icfi.com



IMS, INC.

3901 Calverton Blvd., Suite 200
Calverton, MD 20705
Tel: 301-680-9770
Contact: David Annett
Email: annettd@imsweb.com

KENTUCKY CANCER REGISTRY

2365 Harrodsburg Road, Suite A230
Lexington, KY 40504
Tel: 859-218-6227
Contact: Eric Durbin
Email: ericd@kcr.uky.edu



MISSOURI CANCER REGISTRY AND RESEARCH CENTER (MCR-ARC)

401 Clark Hall
Columbia, MO 65211-4380
Tel: 573-882-7775
Contact: Jeannette Jackson-Thompson
Email: Jacksonthompsonj@health.missouri.edu
This project was supported in part by a cooperative agreement between the Centers for Disease Control and Prevention (CDC) and the Missouri Department of Health and Senior Services (DHSS) (#U58/DP003924-03) and a Surveillance Contract between DHSS and the University of Missouri.



NATIONAL CANCER REGISTRARS ASSOCIATION

1330 Braddock Place, Suite 520
Alexandria, VA 22314-1650
Tel: 703-299-6640 ext 322
Contact: Paula Spitler
Email: pspitler@ncra-usa.org



NORTH AMERICAN ASSOCIATION OF CENTRAL CANCER REGISTRIES, INC. (NAACCR, INC.)

2121 W. White Oaks Dr., Suite B
Springfield, IL 62704
Tel: 217-698-0800, ext. 1
Contact: Monica Thornton
Email: mthornton@naaccr.org
info@naaccr.org



REGISTRY PARTNERS, INCORPORATED

2607 Holly Hill Street, Suite D
Burlington, NC 27215
Tel: 336-226-3359
Contact: Stacey Wertz
Email: staceywertz@registrypartners.com



RTI HEALTH SOLUTIONS

200 Park Offices Drive
Research Triangle Park, NC 27703
Tel: 919-541-5925
Contact: Peter Wirth
Email: pwirth@rti.org



WESTAT

1500 Research Blvd.
Rockville, MD 20850
Tel: 301-738-3557
Contact: Marsha Dunn
Email: marshadunn@westat.com

WELCOME TO NAACCR 2015

Welcome to NAACCR 2015!

On behalf of the Board of Directors, the Program Committee welcomes you to the 2015 Annual Conference of the North American Association of Central Cancer Registries, Inc. (NAACCR) being held in Charlotte, North Carolina. We hope you will enjoy participating in the conference and pre-conference sessions and take advantage of the educational activities available during the 2015 Annual Conference.

The theme for the 2015 Conference is “First in Flight: Launching a New Era in Cancer Surveillance.” The goals of this conference are to highlight the changing landscape of cancer surveillance and research activities and explore the new era and opportunities to enhance cancer surveillance. This year’s plenary themes include “Launching a New Era in Cancer Research,” “Big Data,” “Launching a New Era of Registry Operations” and “Intersection of Public Health Surveillance and Clinical Medicine.”

The concurrent sessions of the conference will cover a wide range of topics such as enabling research, cancer genomics, tissue repositories, Virtual Pooled Registry, big data, innovations in central cancer registry operations, working sessions on XML structured data and a vision of using cancer registries to improve cancer control.

The 2015 Conference is being held at the Westin Charlotte, situated in the heart of the city’s central uptown district and home to a wealth of cultural and entertainment centers. Some of the nearby attractions include the Mint Museum Uptown, NASCAR Hall of Fame, Bank of America Stadium (home of the Carolina Panthers), Time Warner Arena (home of the Charlotte Bobcats), the new Bechtler Museum of Modern Art, Wells Fargo History Museum and the Harvey B. Gantt African American Cultural Center. In addition, there are a host of dining and entertainment venues, just a few blocks away.

We hope that you will have a great experience at this year’s conference and make it a memorable one.

Chandrika Rao

Chandrika Rao

Program Committee Chair, NAACCR Conference, 2015

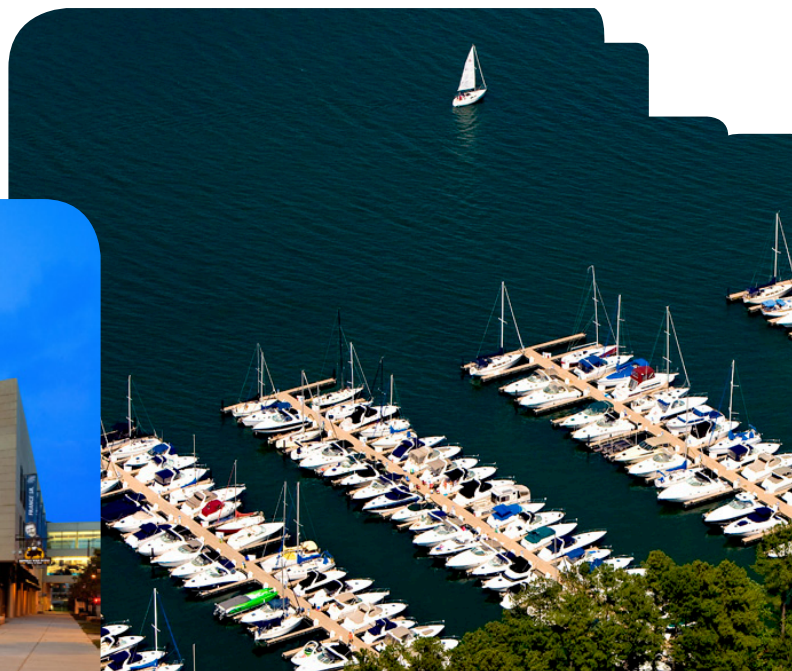

WELCOME FROM THE PRESIDENT

Dear NAACCR Members and Guests;

Welcome to Charlotte, North Carolina for the NAACCR 2015 Annual Conference. As you know our theme this year is *First in Flight: Launching a New Era in Cancer Surveillance*. This is a perfect metaphor for our program. Orville and Wilbur Wright felt the Outer Banks of North Carolina was the perfect place to test their new flying machine. Capturing the Wright brothers' spirit, Charlotte will be the perfect place to showcase our new flying machines that is, our advances in cancer surveillance and control through new approaches, new methodology, new partners and new technology.

As the diagnosis, treatment and overall management of cancer rapidly evolve, we as surveillance professionals must keep up with the science. Our data systems are working smarter. Our operational approaches to 'completeness, timeliness and quality' are embracing new methodology. We are joining forces with partners in different fields and attacking our issues through a multi-disciplinary approach. The value of our population-based research is expanding. We must not take our foot off the gas pedal.

This year's program committee has done an outstanding job in bringing together an amazing program that will share and highlight some exciting new approaches in different areas of cancer surveillance. Just as the Wright brothers continued the advancement of aviation science with their first 12 second flight in 1903, so too will the NAACCR professionals continue the advancement of cancer surveillance and cancer control in 2015 and beyond. Just think what our technology allows us to do in 12 seconds.....

Thank you for your support of NAACCR and for participating in this wonderful meeting located in an amazing city. I hope you will enjoy your time with us.

Best Wishes,

Jill A. MacKinnon, PhD, CTR

President

North American Association of Central Cancer Registries

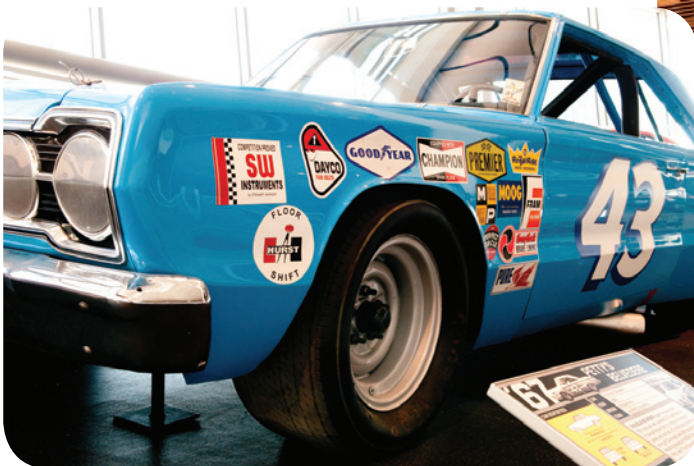

BOARD MEMBERS



PRESIDENT

Dr. Jill A. MacKinnon (2012-2016)
Florida
Miami, FL 33101
Phone: (305) 298-1003
Email: jill_mackinnon@miami.edu



PRESIDENT-ELECT

Dr. Charles Wiggins (2013-2015)
New Mexico Tumor Registry
Phone: (505) 272-8594
Email: cwiggins@salud.unm.edu



TREASURER

Susan T. Gershman, MS, MPH, PhD, CTR
(2011-2015)
Massachusetts Cancer Registry
Department of Public Health
Phone: (617) 624-5646
Email: susan.gershman@state.ma.us



EX-OFFICIO EXECUTIVE DIRECTOR

Betsy A. Kohler, MPH, CTR
NAACCR, Inc.
Phone: (217) 698-0800 Ext. 2
Email: bkohler@naaccr.org

Representative, Sponsoring Member Organizations



Lori Swain (2014-2016)
National Cancer Registrars Association
Phone: (703) 299-6640 Ext. 313
Email: lswain@ncra-usa.org

Representatives-at-Large



Christopher Johnson (2014-2016)
Cancer Data Registry of Idaho
Phone: (208) 489-1380
Email: cjohnson@teamiha.org



Eric B. Durbin, DrPH, MS (2013-2015)
Kentucky Cancer Registry
Phone: (859) 218-3179
Email: ericd@kcr.uky.edu



Francis P. Boscoe, PhD (2014-2016)
New York State Cancer Registry
Phone: (518) 474-2255
Email: fpb01@health.state.ny.us



Kim Vriends, BHA, CHIM (2012-2016)
Prince Edward Island Cancer Registry
Phone: (902) 894-2167
Email: kavriends@gov.pe.ca



Maureen MacIntyre, MHSA (2014-2015)
Surveillance and Epidemiology Unit
Cancer Care Nova Scotia
Phone: (902) 473-6084
Email: maureen.macintyre@ccns.nshealth.ca



Winny Roshala, BA, CTR (2013-2015)
Cancer Registry of Greater California
Phone: (916) 779-0313
Email: wroshala@crgc-cancer.org

CONFERENCE OBJECTIVES+ PROGRAM COMMITTEE



The theme this year is: *"First in Flight: Launching a New Era in Cancer Surveillance."* The 2015 conference will provide attendees with the opportunity to learn from national experts in cancer surveillance, cancer registry operations, and cancer research. Sessions will explore the new era in cancer surveillance from multiple perspectives in North America.

Sponsors & Partners in Cancer Surveillance

Canadian Partnership Against Cancer
College of American Pathologists
(SNOMED Terminology Solutions)
Centers for Disease Control and Prevention
National Cancer Institute
National Cancer Registrars Association
Public Health Agency of Canada
American Cancer Society
American College of Surgeons
American Joint Committee on Cancer

2015 NAACCR Annual Conference Program Committee Members

Thanks to all the members of the 2015 Program Committee for their time and guidance in planning the 2015 conference!

Name	Affiliation
Chandrika Rao-Chair	North Carolina Cancer Registry
Rashid Ahmed	Manitoba Cancer Registry
Frances Babcock	Centers for Disease Control and Prevention - NPCR
Charlie Blackburn	NAACCR
Susan Bolick	South Carolina Central Cancer Registry
Brenda Edwards	National Cancer Institute
Susan T. Gershman	Massachusetts Cancer Registry
Annette Hurlbut	Elekta
Marta Induni	Cancer Registry of Greater California
Betsy A. Kohler	NAACCR
Nancy Lozon	Metropolitan Detroit Cancer Surveillance System
Marueen MacIntyre	Nova Scotia Surveillance and Epidemiology Unit
Jill MacKinnon	NAACCR President
Jim Martin	Virginia Cancer Registry
Lynne Penberthy	National Cancer Institute
Rich Pinder	Los Angeles Cancer Surveillance Program
Laura Ruppert	Indiana State Department of Health
Jeannette Jackson-Thompson	Missouri Cancer Registry and Research Center
Monica Thornton	NAACCR
Shannon Vann	NAACCR
Hannah Weir	Centers for Disease Control and Prevention - NPCR

CONFERENCE INFORMATION

CONFERENCE REGISTRATION INFORMATION

The Conference Registration and Information Desk is located outside the Grand Ballroom in the Grand Promenade on Level 2 and is open during the following days and times:

Monday, June 15	9:00 am to 7:00 pm
Tuesday, June 16	7:00 am to 5:00 pm
Wednesday, June 17	7:30 am to 11:45 am
Thursday, June 18	7:00 am to 11:30 am

Pre-Conference registration and check-in desks are located outside the Pre-Conference rooms.

Any inquiries about the conference, social functions, etc., may be answered by any of the staff at the registration desk. Registered participants will receive their conference documents and badges at the registration desk. **Please note** that entrance to the Tuesday Reception and Wednesday Awards Luncheon is by ticket only. Please be sure to wear your name badge to all social events, workshops, and sessions.

SESSIONS / BUSINESS MEETING

All Plenary Sessions, Concurrent Sessions and the Business Meeting will take place on Level 2 and the Lobby Level. The Plenary Sessions and the Business meeting will be held in the Providence Ballroom on the Lobby Level.

OPENING RECEPTION

Tuesday, June 16, 2015

The Opening Reception will be held in the Providence Ballroom on the Lobby Level at 6:30 pm. It serves as the perfect gathering place to enjoy networking, light refreshments, fabulous foods, and some unique entertainment.

CONTINUING EDUCATION CREDITS

Continuing Education credit is provided by the National Cancer Registrars Association (NCRA). You will be able to conveniently download the 2015 NAACCR Annual Conference CE Hours Form from the NAACCR website at www.naacccr.org/educationandtraining/annualconference.aspx

EXHIBITS AND POSTER INFORMATION

Exhibits and Posters will be located in Grand Ballroom C/D on Level 2.

All delegates are encouraged to take the opportunity to visit the exhibits and posters to become familiar with some of the latest advances and research in the field.

They will be available at these times:

Exhibit Hours:

Monday, June 15	5:30 pm to 7:00 pm
Tuesday, June 16	7:00 am to 5:00 pm
Wednesday, June 17	7:00 am to 11:45 am
Thursday, June 18	7:00 am to 10:00 am

CYBER CAFÉ

The Cyber Café is located within the Exhibit area and can be accessed during exhibition hours.

CONFERENCE EVALUATIONS

2015 conference evaluations will be available in electronic format only.

Please visit:

www.naacccr.org/educationandtraining/annualconference.aspx

to complete your evaluation. All delegates will be emailed reminders and links to the evaluation after the conference.

WESTIN CHARLOTTE HOTEL FLOOR PLANS

LOBBY

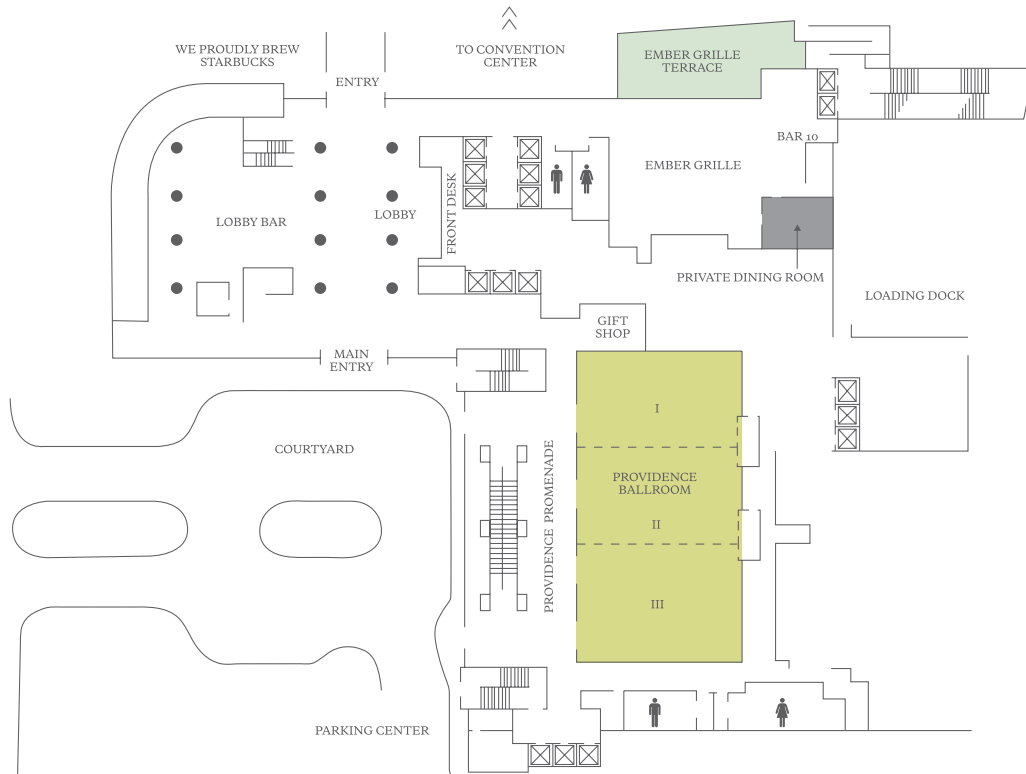

SECOND FLOOR



PROGRAM + AGENDA

SATURDAY, JUNE 13 [PRE-CONFERENCE]

TIME	LOCATION	EVENT
8:30am-5:30pm	Trade Room - Level 2	Basic SEER*Stat Software Training <i>Course Organizer: Carol Kosary, NCI</i>

SUNDAY, JUNE 14 [PRE-CONFERENCE]

8:30am-5:30pm	Trade Room - Level 2	Advanced SEER*Stat Software Training <i>Course Organizer: Carol Kosary, NCI</i>
9:00am-1:00pm	Tryon Room - Level 2	Geocoding Operations Short Course <i>Course Organizer: Recinda Sherman, NAACCR</i>
9:00am-5:00pm	Brevard Room - Level 3	NAACCR Board of Directors Meeting

MONDAY, JUNE 15 [PRE-CONFERENCE]

7:00am-9:00am	Brevard Room - Level 3	NAACCR Board of Directors Meeting Day #2 (if necessary)
8:00am-12:00pm	Trade Room - Level 2	SEER*Prep Software Training <i>Course Organizer: Carol Kosary, NCI</i>
9:00am-7:00pm	Grand Promenade - Level 2	NAACCR Registration Check-In
9:00am-10:30am	Tryon Room - Level 2	Communications Steering Committee Meeting Communications Priority Area Network Meeting (All welcome to attend PAN meeting)
9:00am-10:30am	Independence Room - Level 2	Professional Development Steering Committee Meeting Professional Development Priority Area Network Committee Meeting (All welcome to attend PAN meeting)
10:00am-11:00am	Harris Room - Level 2	Uniform Data Standards Work Group Meeting
10:30am-12:00pm	Sharon Room - Level 2	Research and Data Use Steering Committee Meeting Research and Data Use Priority Area Network Meeting (All welcome to attend PAN meeting)
12:00pm-2:00pm	Independence Room - Level 2	Board/Chair Training
1:00pm-5:00pm	Grand Ballroom C/D - Level 2	Exhibitor and Poster Set-up
2:00pm-3:30pm	Harris Room - Level 2	Standardization and Registry Development Steering Committee Meeting
3:30pm-4:30pm	Harris Room - Level 2	Standardization and Registry Development Priority Area Network Meeting (All welcome to attend PAN meeting)
3:30pm-4:30pm	Kings Room - Level 2	Strategic Alliances Steering Committee Meeting
5:30pm-7:00pm	Grand Ballroom C/D - Level 2	Exhibitor Showcase and Poster Pre-Viewing <i>Join us in the exhibit hall to visit with the conference exhibitors, pre-view scientific posters, and meet friends before you head out for dinner in Charlotte. Cash bar and complimentary light appetizers will be available.</i>
6:30pm-7:00pm	Grand Ballroom C/D - Level 2	NAACCR Program Committee Reception <i>Program Committee members please meet in the designated area of the exhibit hall.</i>
7:00 pm	Meet in lobby	GSADD Geospatial and Demographic Workgroup Meet in Lobby for Dinner <i>Are you interested in GIS, area-based analysis, or geospatial epidemiology? Please join like-minded folks from the Geography, Spatial and Demography Data (GSADD) group for a no-host dinner. We are guaranteed to be lively and possibly even productive.</i>

TUESDAY, JUNE 16 | MORNING & AFTERNOON

TIME	LOCATION	EVENT		PRESENTER
6:30am-8:00 am	Grand Ballroom C/D - Level 2	Breakfast		
7:00am-8:00am	Grand Ballroom A - Level 2	NAACCR Roundtable <i>Meet NAACCR Board Members, the NAACCR staff, and other NAACCR members to learn more about how to become involved. Bring your breakfast and attend this session to find out "Everything You Wanted to Know About NAACCR but Were Afraid to Ask."</i>		
7:00am-5:00 pm	Grand Promenade - Level 2	NAACCR Registration Desk		
7:00am-5:00 pm	Grand Ballroom C/D - Level 2	Exhibit Hall Open		
7:00am-5:00 pm	Grand Ballroom C/D - Level 2	Poster Viewing Open		
8:00am-8:30 am	Providence Ballroom - Lobby Level	Opening Ceremonies and Welcome Launching a New Era in Research <i>Moderator:</i> <i>Charles Wiggins</i>		
8:30am-9:15am	Providence Ballroom - Lobby Level	KEYNOTE ADDRESS: The Right Treatment for the Right Patient at the Right Time: A Perspective on Personalized Cancer Medicine <i>Keynote Speaker: Marie Davidian, PhD, Professor of Statistics, North Carolina State University</i>		
9:15am-10:00am	Providence Ballroom - Lobby Level	Enabling Research: Biospecimen-Based Research on the Genomics of Prostate Cancer Disparities <i>Steven R. Patierno, PhD, Deputy Director, Duke Cancer Institute</i>		
10:00am-10:30am	Grand Ballroom C/D - Level 2	Break/Poster Viewing/Exhibits		
10:30am-12:30pm	Providence Ballroom - Lobby Level	PLENARY SESSION 1 Launching a New Era in Research-Applications for Cancer Registries <i>Moderator:</i> <i>Betsy A. Kohler</i>	10:30am-11:00am	Cancer Care Delivery Research and the SEER Program: Challenges and Opportunities <i>Steven Katz, MD, Professor of Medicine and Health Management and Policy, University of Michigan</i>
			11:00am-11:25am	Maximizing the Potential of Population-Based Cancer Registries to Inform Cancer Research <i>Thomas C. Tucker, PhD, Director, Kentucky Cancer Registry, University of Kentucky</i>
			11:25am-11:50am	Advancing Cancer Research Through a Virtual Pooled Registry <i>Dennis Deapen, DrPH, Director, Los Angeles Cancer Surveillance Program, University of Southern California</i>
			11:50am-12:15pm	The Draft NAACCR XML Data Standard: Keeping Pace with the New Era in Cancer Research and Surveillance <i>Eric Durbin, PhD, Director, Cancer Research Informatics, Kentucky Cancer Registry, University of Kentucky</i>
			12:15pm-12:30pm	Panel Discussion and Interactive Poll with Audience
12:30pm-1:30pm	Grand Ballroom C/D - Level 2	Lunch on Your Own/Poster Viewing/Exhibits		

PROGRAM + AGENDA

TUESDAY, JUNE 16 | AFTERNOON

TIME	LOCATION	EVENT
12:30pm-1:30pm	Sharon Room - Level 2	MTC Registry Luncheon - Invited Meeting
1:30pm-3:00pm	CONCURRENT SESSION 1	
Section A: Registry Operations: Case Ascertainment <i>Moderator:</i> <i>Winnie Roshala</i>	Grand Ballroom A - Level 2	001 Finding the Needle in the Haystack — The Clinically Diagnosed Cases <i>M. Potts, Fred Hutchinson Cancer Research Center, Seattle, WA, United States</i>
		002 Using NPI and ePath to Identify Clinics That Treat or Diagnose Cancer <i>C. Klaus, North Carolina Central Cancer Registry, Raleigh, NC, United States</i>
		003 Quality Control of Alternate Data Sources in the Ontario Cancer Registry <i>M.J. King, Cancer Care Ontario, Toronto, ON, Canada</i>
		004 What Can We Learn About Case Ascertainment from Registries with High Incidence for Either Benign/Borderline Brain or In Situ Breast Cancers? <i>R.L. Sherman, NAACCR, Springfield, IL, United States</i>
Section B: Launching a New Era of Data Transmission - XML <i>Moderator:</i> <i>Gary M. Levin</i>	Come join members of the XML Task Force for three presentations about XML - what it is, how we envision using it for NAACCR, and tools we've built to take us between Flat File and XML (and back again!). This themed breakout session will have plenty of time for discussion and questions.	
	Grand Ballroom B - Level 2	005 Introduction to XML– How it Works and What it Offers Us <i>R. Pinder, Los Angeles Cancer Surveillance Program, Los Angeles, CA, United States</i>
		006 Creating, Transmitting, and Working with a NAACCR XML File <i>I. Hands, Kentucky Cancer Registry, Lexington, KY, United States</i>
		007 XML Tools - Examples to Slice, Dice, Load, and Analyze XML Data <i>F. Depry, Information Management Services, Inc., Silver Spring, MD, United States</i>
		008 After the last speaker the audience will have the opportunity for Q&A and discussion with the speakers.
Section C: Cancer Survival <i>Moderator:</i> <i>Hannah K. Weir</i>	Tryon Room - Level 2	009 Preview of Registry-Specific and Aggregated Relative Survival Estimates in Cancer in North America <i>C.J. Johnson, Cancer Data Registry of Idaho, Boise, ID, United States</i>
		010 To What Extent Do National Wealth and Expenditure on Health Explain World-Wide Variation in Cancer Survival? <i>C. Allemani, London School of Hygiene and Tropical Medicine, London, United Kingdom</i>
		011 Lower Mortality Among Married Cancer Patients: How Much of The Effect is Explained by Socioeconomic and Health Insurance Status? <i>S. Gomez, Cancer Prevention Institute of California, Fremont, CA, United States</i>
		012 Understanding International Disparities in Childhood Leukaemia Survival: A Worldwide Analysis from the CONCORD-2 Study <i>A. Bonaventure, Cancer Research UK Cancer Survival Group, Department of Non-Communicable Disease Epidemiology, London School of Hygiene and Tropical Medicine, London, United Kingdom</i>

TUESDAY, JUNE 16 | AFTERNOON

TIME	LOCATION	EVENT
1:30pm-3:00pm	CONCURRENT SESSION 1 Continued	
Section D: Improving Data Quality Moderator: Susan T. Gershman	Harris Room - Level 2	013 Using Cancer Registry Data to Evaluate Breast Cancer Incidence by Subtype <i>R.L. Sherman, NAACCR, Springfield, IL, United States</i>
		014 Completeness and Consistency of WHO Grade Assignment for Brain and Central Nervous System Tumors in the United States, 2004-2011 <i>J. Barnholtz-Sloan, Central Brain Tumor Registry of the United States, Hinsdale, IL, United States Case Comprehensive Cancer Center, Case Western Reserve University School of Medicine, Cleveland, OH, United States</i>
		015 The Impact of Reporting Practices on State and Local Lip Cancer Rates, or: How Many per Million Depends on the Vermilion <i>F.P. Boscoe, New York State Cancer Registry, Albany, NY, United States</i>
		016 Quality Analysis and Coding Recommendations for Prostate Cancer Site Specific Factors, 2004-2012 <i>J. Whitlock, Wayne State University School of Medicine, Detroit, MI, United States Barbara Ann Karmanos Cancer Institute, Detroit, MI, United States</i>
Section E: Launching a New Era of Surveillance: Biomarkers and Prognostic Indicators Moderator: Frances Babcock	Trade Room - Level 2	017 Determining How to Move Forward with Collection of Prognostic and Predictive Factors Known as CS SSFS <i>V. Petkov, National Cancer Institute, Rockville, MD, United States</i>
		018 An In-Depth Study of KRAS Biomarker Testing in Colorectal Cancer Patients <i>A. Rico, CDC, Atlanta, GA, United States</i>
		019 Linking Oncotype DX Results to SEER Data and Patient-Report to Assess Challenges in Individualizing Breast Cancer Care <i>A. Hamilton, Keck School of Medicine, University of Southern California, Los Angeles, CA, United States Los Angeles Cancer Surveillance Program, Los Angeles, CA, United States</i>
		020 Use of the Oncotype DX Assay Among California Breast Cancer Patients – An Analysis of Linked Databases <i>R.D. Cress, Public Health Institute/Cancer Registry of Greater California, Sacramento, CA, United States</i>
3:00pm-3:30pm	Grand Ballroom C/D - Level 2	Break/Poster Viewing/Exhibits
3:30pm-5:00pm	CONCURRENT SESSION 2	
Section A: Registry Operations Improving Data Quality Moderator: John Keighly	Grand Ballroom A - Level 2	021 Focused Audits - A Novel Approach to Monitoring Data Quality in the Central Registry <i>C. Moody, California Cancer Registry, Sacramento, CA, United States</i>
		022 Assessing the Completeness of Birthplace Information Collected by the California Cancer Registry <i>L. Liu, Los Angeles Cancer Surveillance Program, Los Angeles, CA, United States</i>
		023 Cancer Registry of Greater California (CRGC) Identifies Adolescent Cases Considered Lost to Follow Up In Order to Improve Follow Up <i>G. Halvorson, Cancer Registry of Greater California, Sacramento, CA, United States</i>
		024 Understanding and Developing Approaches for Addressing Differential Follow-Up Among Asian and Hispanic Cancer Cases <i>S. Gomez, Cancer Prevention Institute of California, Fremont, CA, United States</i>

PROGRAM + AGENDA

TUESDAY, JUNE 16 | AFTERNOON

TIME	LOCATION	EVENT
3:30pm-5:00pm	CONCURRENT SESSION 2 Continued	
Section B: Launching a New Era in Data Linkage <i>Moderator:</i> David P. Butterworth	Grand Ballroom B - Level 2	025 Use of Alternate Information to Improve Linkage with the National Death Index (NDI) <i>E. Miller, Centers for Disease Control and Prevention, Hyattsville, MD, United States</i>
		026 Linking Cancer Registries and Birth Defects Registries for Clues on Genetic Cancer Risk <i>G. Copeland, Michigan Cancer Surveillance System, MDCH, Lansing, MI, United States</i>
		028 Health Status of Florida Cancer Survivors: Linkage of the 1986-2009 National Health Interview Survey (NHIS) with the 1981-2010 Florida Cancer Data System (FCDS) <i>D.J. Lee, University of Miami, Miller School of Medicine, Miami, FL, United States</i>
Section C: Cancer Patterns <i>Moderator:</i> Laura P. Ruppert	Tryon Room - Level 2	029 When will Cancer Become the Leading Cause of Death in the United States? <i>H. Weir, Centers for Disease Control and Prevention, Atlanta, GA, United States</i>
		030 2011 US Burden of Cancer by Race and Ethnicity <i>J. Lortet-Tieulent, American Cancer Society, Atlanta, GA, United States</i>
		031 Changes in Most Common Cancers in Canada <i>L. Xie, Centre for Chronic Disease Prevention, Public Health Agency of Canada, Ottawa, ON, Canada</i>
		032 Estimating the Impact of Childhood Cancer in the United States: Years of Life Lived with Disease and Years of Potential Life Lost, 2009 <i>J. Barnholtz-Sloan, Central Brain Tumor Registry of the United States, Hinsdale, IL, United States / Case Comprehensive Cancer Center, Case Western Reserve University School of Medicine, Cleveland, OH, United States</i>
Section D: Launching a New Era of Cancer Staging <i>Moderator:</i> Kim A. Vriends	Harris Room - Level 2	033 Survey of Users of Staging Data: What Data is Used, What Data Should be Collected? <i>J. Brierley, Canadian Partnership Against Cancer, Toronto, ON, Canada / Princess Margaret Cancer Centre, Toronto, ON, Canada</i>
		034 SEER 2014 Training Assessment for TNM Staging <i>A-M. Noone, National Cancer Institute, Bethesda, MD, United States</i>
		035 Evaluation of TNM Staging Data in a Large Volume of Cancer Pathology Reports Using Automated Data Extraction and Analysis <i>C. Kosary, National Cancer Institute, Rockville, MD, United States</i>
		036 Discordance and Missing of Staging Information in Cancer Registry Data: Implications for CER in Bladder Cancer <i>K. Meng, The University of North Carolina at Chapel Hill, Chapel Hill, NC, United States</i>



TUESDAY, JUNE 16 | EVENING

TIME	EVENT	
3:30pm-5:00pm	CONCURRENT SESSION 2 Continued	
Section E: A New Era in Data Interpretation <i>Moderator:</i> <i>Netta N. Apedoe</i>	Trade Room - Level 2	037 Changing Incidence of Hodgkin Lymphoma Histologic Subtypes: Risk Factor Trends or Evolving Diagnostic Practice? <i>S. Glaser, Cancer Prevention Institute of California, Fremont, CA, United States / Department of Health Research and Policy (Epidemiology), Stanford University, Stanford, CA, United States</i>
		038 Evaluation of Completeness of Lymph Node Count in the North American Association of Central Cancer Registries for Selected Cancers <i>H.M. Sineshaw, American Cancer Society, Atlanta, GA, United States</i>
		039 Has Improved Imaging Contributed to Reduced Size at Diagnosis for Stage I Lung Adenocarcinomas? <i>J.W. Morgan, Loma Linda University School of Public Health, Loma Linda, CA, United States / SEER Cancer Registry of Greater California, Loma Linda, CA, United States</i>
		040 Population-Based Testing and Treatment Characteristics for CML <i>T. Styles, Centers for Disease Control and Prevention, Atlanta, GA, United States</i>
5:15pm-6:15pm	Registry of the Future Open Forum (Two Sessions) Come join us to discuss what cancer surveillance systems will look like in the future! Help answer questions about data linkages, real time reporting, new data sources and new data sets, and sharing resources across registries. Join us in one of the two sessions!	
	Grand Ballroom A - Level 2	Registry of the Future Open Forum - Operations Section
	Grand Ballroom B - Level 2	Registry of the Future Open Forum - Research Section
6:30pm-9:00pm	Providence Ballroom - Lobby Level	Opening Reception <i>All conference attendees are encouraged to attend the 2015 Opening Reception. This is a great opportunity to meet with friends and colleagues. You also will be sure to make new acquaintances and to expand your professional network. Local cuisine will be available making this a can't miss event! Cash bar.</i>

**ENTER TO WIN A GOOGLE™ NEXUS 9 TABLET**

Don't forget to get your Scientific Poster and Exhibitor Passport marked for your chance to enter the drawing to win 1 of 2 Google™ Nexus 9 Tablets.

Drawing will be on **Thursday at 10:00 am** in Plenary Session 3. Need not be present to win.

PROGRAM + AGENDA

WEDNESDAY, JUNE 17 | MORNING

TIME	LOCATION	EVENT		PRESENTER
6:30am-8:00am	Grand Ballroom C/D - Level 2	Breakfast		
7:00am-8:00am	Grand Ballroom A - Level 2	Birds of a Feather Round Table Discussion <i>Using Our Registry Data – What Works and What’s Next?</i>		
7:00am-11:45am	Grand Ballroom C/D - Level 2	Exhibit Hall Open		
7:00am-11:45am	Grand Ballroom C/D - Level 2	Poster Viewing Open		
7:30am-11:45am	Grand Promenade - Level 2	NAACCR Registration Desk		
8:30am-9:45am	Providence Ballroom - Lobby Level	PLENARY SESSION 2 Big Data! <i>Moderator: Lynne Penberthy</i>	8:30am-9:00am	Unleashing “Big Data” in Oncology <i>Robert Green, MD MSCE, Vice President of Clinical Strategy, Flatiron Health, Inc.</i>
			9:00am-9:30am	Big Data Infrastructure for Cancer Outcomes <i>Anne-Marie Meyer, Faculty Director, ICISS, UNC</i>
			9:30am-9:45am	Discussion with Audience
9:45am-10:00am	Grand Ballroom C/D - Level 2	Break/Poster Viewing/Exhibits		
10:00am-11:30am	CONCURRENT SESSION 3			
Section A: Registry Operations Launching a New Era in Quality Improvement <i>Moderator: Cheryl Moody</i>	Grand Ballroom A - Level 2	041	A New Era of Data Quality Assurance and Process Improvement <i>W. Roshala, PHI/Cancer Registry of Greater California, Sacramento, CA, United States</i>	
		042	Remedy to Reduce Death Certificate Only Cases <i>S. Radhakrishnan, North Carolina Cancer Registry, Raleigh, NC, United States</i>	
		043	A Review of 2012 Diagnosis Year Cases Submitted from Seven Pathology Laboratories in Illinois <i>L. Koch, Illinois State Cancer Registry, Springfield, IL, United States</i>	
		044	Engaging Regional Cancer Centre Healthcare Professionals in Identifying Cancer Surveillance Informational Needs <i>N. Solimani, Cancer Care Ontario, Toronto, ON, Canada</i>	
Section B: Projections, Prevalence and Partitions <i>Moderator: Brenda K. Edwards</i>	Grand Ballroom B - Level 2	045	Early Estimates of SEER Cancer Incidence for 2012 <i>D.R. Lewis, National Cancer Institute, Bethesda, MD, United States</i>	
		046	Projecting Cancer Prevalence: Finding the Best Methods For Ontario's Cancer System Planning <i>D. Nishri, Cancer Care Ontario, Toronto, ON, Canada</i>	
		047	Use of Incidence-Based Mortality (IBM) Tool to Partition Trends in Mortality by Tumor Subtypes: Application to Non-Hodgkin Lymphoma (NHL) Cancer <i>N. Howlander, NCI/NIH, Washington, DC, United States</i>	
		048	Reducing Confounding Bias in Registry-Linked Data Through Propensity Score Methods <i>Y.K. Chang, Lineberger, UNC-CH, Chapel Hill, NC, United States</i>	

WEDNESDAY, JUNE 17 | MORNING & AFTERNOON

TIME	LOCATION	EVENT
10:00am-11:30am	CONCURRENT SESSION 3 Continued	
Section C: Launching a New Era in Geographic Analysis <i>Moderator:</i> <i>Recinda Sherman</i>	Tryon Room - Level 2	049 Assessing Fitness for Use of Two Indicators of the Rural-Urban Environment in the NAACCR Data Files <i>K.A. Henry, Temple University, Philadelphia, PA, United States</i>
		050 County Measures and Cancer Survival for Lung and Colorectal Cancer in Appalachian Kentucky, Ohio and West Virginia <i>B. Huang, University of Kentucky, Lexington, KY, United States</i>
		051 Mapping with Cancer, Demographic and Behavioral Risk Data <i>C. Schmaltz, Missouri Cancer Registry and Research Center, Columbia, MO, United States</i>
		052 Are Distance Based on Addresses Better than ZIP Codes for Assessing Geographic Access to Cancer Treatment? <i>T. Kuo, LCCC, UNC-CH, Chapel Hill, NC, United States</i>
Section D: Launching a New Era in Cancer Control <i>Moderator:</i> <i>Jeannette Jackson-Thompson</i>	Harris Room - Level 2	053 Building Capacity for Cancer Control Action: the IARC Regional Hub for Cancer Registration in the Caribbean <i>D. Martin, National Cancer Institute, National Institute of Health, Rockville, MD, United States</i>
		054 Profiling Cancer Within Select Ontario Aboriginal Reserves <i>M.V. Prummel, Prevention and Cancer Control, Cancer Care Ontario, Toronto, ON, Canada</i>
		055 Smoking Behavior Among Adult Childhood Cancer Survivors: What Are We Missing? <i>T. Asfar, Department of Public Health Sciences, University of Miami Miller School of Medicine, Miami, FL, United States</i>
		056 Use of Patient Focus Group Data with Cancer Registry Data to Support Person-Centered System Performance Reporting <i>K. Tran, Canadian Partnership Against Cancer, Toronto, ON, Canada</i>
Section E: New Era in Research: Cervical Cancer Surveillance <i>Moderator:</i> <i>Deirdre B. Rogers</i>	Trade Room - Level 2	057 Surveillance of Cervical Cancer Precursors in Four U.S. Central Cancer Registries <i>M. Watson, Division of Cancer Prevention and Control, Centers for Disease Control and Prevention, Atlanta, GA, United States</i>
		058 Audit of Case Finding Completeness and Accuracy in Four Registries Collecting Cervical Cancer Precursors <i>M. Watson, Division of Cancer Prevention and Control, Centers for Disease Control and Prevention, Atlanta, GA, United States</i>
		059 HPV Genotype Prevalence Among Kentucky Women Diagnosed with Pre-Invasive Cervical Cancer: Using the Central Cancer Registry as a Population-Based Virtual Tissue Repository <i>T. Tucker, University of Kentucky, Lexington, KY, United States</i>
		060 Leveraging Electronic Pathology Reporting in Cervical Cancer Epidemiology: Determinants of Invasive Diagnoses in Kentucky <i>E. Durbin, Kentucky Cancer Registry, Lexington, KY, United States</i>
11:30am-11:45am	Providence Ballroom - Lobby Level	Brief Transition Break to Luncheon
11:45am-1:00pm	Providence Ballroom - Lobby Level	Luncheon and Awards Ceremony

WEDNESDAY, JUNE 17

PROGRAM + AGENDA

WEDNESDAY, JUNE 17 | AFTERNOON

TIME	LOCATION	EVENT
1:00pm-2:30pm	Providence Ballroom - Lobby Level	NAACCR Business Meeting <i>All conference delegates are invited to attend the 2015 NAACCR Business Meeting. Important activities will be voted on. Other critical business of the Association will also be presented.</i> Voting Delegates from their respective organizations are required to attend the NAACCR Business Meeting.
2:30pm-3:15 pm	Providence Ballroom - Lobby Level	The FORDS Revision Project <i>A major revision of the Commission on Cancer FORDS Manual has been launched and will represent the collective work of all stakeholder groups. Dr. Frederick L. Greene, Chair of this revision process, will update the attendees and outline the implication of the process for all who depend on modern coding of cancer for clinical care and research. This will be an interactive session outlining the initial process and the future strategy of the national steering committee.</i>
4:00pm	Meet in Hotel Lobby	Bike Event <i>NAACCR promotes healthy lifestyles through our Wednesday Fun Bike Ride. Come join us for a leisurely bike ride around Charlotte! We're going to join the green cycling movement and use the bikes from Charlotte's BikeShare program called Charlotte B-Cycle. Charlotte B-Cycle will have staff on hand at 4:00pm to assist at the fully stocked kiosks close to the Westin, and to provide us with helmets for a \$5 charge. Plan to meet in the lobby by 3:45pm so we can begin the ride as soon as possible. We will have a helmet drop off in the Westin Lobby when the ride is complete.</i>



THURSDAY, JUNE 18 | MORNING

TIME	LOCATION	EVENT	PRESENTER
6:30am-8:00am	Grand Ballroom C/D - Level 2	Breakfast	
6:30am	Meet in Hotel Lobby	NAACCR 2015 5K Run/Walk <i>NAACCR encourages all attendees to take advantage of the NAACCR walk/run. It is estimated that over half of cancer cases can be prevented by lifestyle changes such as exercise, the limitation of tobacco use, and improved nutrition. Meet in the hotel lobby to enjoy a nice walk or jog to start your day off right! This is a free event and route maps will be available.</i>	
7:00am-11:30am	Grand Promenade - Level 2	NAACCR Registration Desk	
7:00am-10:00am	Grand Ballroom C/D - Level 2	Exhibit Hall Open	
7:00am-10:00am	Grand Ballroom C/D - Level 2	Poster Viewing Open	
8:00am-9:30am	CONCURRENT SESSION 4		
Section A: Registry Operations Improving Management <i>Moderator:</i> <i>Marta Induni</i>	Grand Ballroom A - Level 2	061 The Last Frontier; True Modernization of a Cancer Registry's Electronic Communication	<i>K. Ziegler, Cancer Registry of Greater California, Sacramento, CA, United States</i>
		062 Using SEER*Educate Management Reports to Target Training Needs	<i>M. Potts, Fred Hutchinson Cancer Research Center, Seattle, WA, United States</i>
		063 Better Communication Starts with Team Work	<i>N. Lozon, Metropolitan Detroit Cancer Surveillance System, Detroit, MI, United States</i>
		064 Benefits and Challenges of Going Paperless: Implementation of a Document Management and Workflow System	<i>C. Hamma, Public Health Institute / Cancer Registry of Greater California, Sacramento, CA, United States</i>
Section B: Meaningful Use <i>Moderator:</i> <i>Joseph Dean Rogers</i>	Grand Ballroom B - Level 2	065 Meaningful Use of Electronic Health Records: Electronic Physician Reporting to State Cancer Registries	<i>W. Blumenthal, CDC, Atlanta, GA, United States</i>
		066 North Carolina Central Cancer Registry (NCCCR) and Meaningful Use Stage 2 Cancer Reporting	<i>N. Salahuddin, NC DHHS, Raleigh, NC, United States</i>
		067 Meaningful Use Stage 3: Potential Impact on Central Cancer Registries	<i>J. Jackson-Thompson, University of Missouri (MU) School of Medicine Department of Health Management & Informatics, Columbia, MO, United States Missouri Cancer Registry and Research Center, Columbia, MO, United States MU Informatics Institute, Columbia, MO, United States</i>
		068 Putting it into Practice: Challenges Implementing MU2 in Florida	<i>M. Hernandez, Florida Cancer Data System, University of Miami Miller School of Medicine, Sylvester Cancer Center, Miami, FL, United States</i>

PROGRAM + AGENDA

THURSDAY, JUNE 18 | MORNING

TIME	LOCATION	EVENT
8:00am-9:30am	CONCURRENT SESSION 4 Continued	
Section C: Survival Methods <i>Moderator:</i> <i>Christopher Johnson</i>	Tryon Room - Level 2	069 The Impact of the “Presumed Alive” Follow-up Method on Survival Rates by Race/Ethnicity and National Origin in New York <i>M.J. Schymura, New York State Cancer Registry, Albany, NY, United States</i>
		070 Constructing Life Tables for Global Surveillance of Cancer Survival: Experience from the CONCORD-2 Study <i>D. Spika, Cancer Research UK Cancer Survival Group, Department of Non-Communicable Disease Epidemiology, London School of Hygiene and Tropical Medicine, London, England, United Kingdom</i>
		071 Multiple Mediation Analysis with Survival Data: An Application to Analyze Racial Disparity in Stage III Colon Cancer Survival <i>M.C. Hsieh, Louisiana Tumor Registry and Epidemiology Program, School of Public Health, LSU Health Sciences Center, New Orleans, LA, United States Department of Biostatistics and Bioinformatics, School of Public Health and Tropic Medicine, Tulane University, New Orleans, LA, United States</i>
		072 Development of New NPCR SAS Tool for Population-Based Cancer Relative Survival Analysis <i>K. Zhang, ICF International, Atlanta, GA, United States</i>
Section D: Launching a New Era in Surveillance and Cancer Outcomes <i>Moderator:</i> <i>David K. O'Brien</i>	Harris Room - Level 2	073 Using Enhanced Registry Data for Clinical Management and Cancer Care <i>V.W. Chen, Louisiana Tumor Registry and Epidemiology Program, School of Public Health, Louisiana State University Health Sciences Center, New Orleans, LA, United States</i>
		074 Variation In Staging and Treatment of Rectal Cancer by National Cancer Institute (NCI) Designation and Medical School Affiliation: Analysis of Surveillance, Epidemiology and End Results (SEER)-Medicare Data <i>M.E. Charlton, University of Iowa College of Public Health, Iowa City, IA, United States</i>
		075 Prevalence and Characteristics of Cancer Patients Seeking Care from Multiple Facilities, San Francisco Bay Area of California, 2010-11 <i>S. Glaser, Cancer Prevention Institute of California, Fremont, CA, United States Stanford Cancer Institute, Palo Alto, CA, United States</i>
		076 Quality of Care and Outcomes Among Cancer Patients in California According to Source of Health Insurance <i>A. Parikh-Patel, California Cancer Reporting and Epidemiologic Surveillance (CalCARES) Program, Institute for Population Health Improvement, UC Davis Health System, Sacramento, CA, United States</i>
Section E: Cancer Epidemiology <i>Moderator:</i> <i>Kathy Cronin</i>	Trade Room - Level 2	077 Increasing Trends of Kidney and Renal Pelvis Cancer in California <i>A. Parikh-Patel, California Cancer Reporting and Epidemiologic Surveillance (CalCARES) Program, Institute for Population Health Improvement, UC Davis Health System, Sacramento, CA, United States</i>
		078 Trends in Early Stage Hepatocellular Carcinoma, California 1988-2011 <i>D. Ewing, Cancer Registry of Greater California, Public Health Institute, Sacramento, CA, United States</i>
		079 Breast Cancer Among the U.S. Male Population <i>R. Wilson, CDC/NCCDPHP/DCPC/CSB, Atlanta, GA, United States</i>
		080 Stomach Cancer in North America: Geographic Variation in Net Survival by Age And Sex <i>H. Carreira, Cancer Research UK Cancer Survival Group, Department of Non-Communicable Disease Epidemiology, London School of Hygiene and Tropical Medicine, London, United Kingdom</i>

THURSDAY, JUNE 18 | MORNING & AFTERNOON

TIME	LOCATION	EVENT	
9:30am-10:00am	Grand Ballroom C/D - Level 2	Morning Break and Exhibits	
9:30am-10:00am	Grand Ballroom C/D - Level 2	Poster Removal	
10:00 am	Providence Ballroom - Lobby Level	Poster and Exhibitor Passport Drawing in Plenary 3	
10:00am-11:00am	Grand Ballroom C/D - Level 2	Exhibit Break Down	
10:00am-11:30am	Providence Ballroom - Lobby Level	PLENARY SESSION 3 Launching a New Era in Registry Operations This interactive session will feature NAACCR members presenting innovative perspectives on Central Cancer Registry Operations. Via onsite polling, the audience will indicate the feasibility of implementing these creative ideas. What’s on the horizon that will change the way we work? <i>Moderator:</i> <i>Maureen MacIntyre</i>	NCI SEER Transition Tools – Moving to More Modern Technologies <i>Jean Cyr, Assistant Project Manager and Senior Systems Analyst, Information Management Systems, Inc.</i>
			Launching a New Era in Registry Operations: Survivorship Care Plans <i>Randi Rycroft, CTR Director, Colorado Central Cancer Registry</i>
			Data Item Consolidation <i>Frances Ross, CTR, Director of Registry Operations, Kentucky Cancer Registry</i>
			The New Death Clearance Manual <i>Susan Bolick, MSPH, CTR, Director, South Carolina Cancer Registry</i>
			Reporting Delay Adjustment for NAACCR Registries <i>Eric Feuer, PhD, Branch Chief, Surveillance Research Program, National Cancer Institute</i>
11:30am-1:00pm		Lunch on Your Own	
1:00pm-2:30pm	CONCURRENT SESSION 5		
Section A: Issues of Race <i>Moderator:</i> <i>Jim Martin</i>	Grand Ballroom A - Level 2	081	Plans for Multi-Race Reporting of Death Data <i>E. Arias, CDC/NCHS, Hyattsville, MD, United States</i>
		082	Feasibility of Multi-Race Reporting for Cancer Incidence <i>D. G. Stinchcomb, Westat, Rockville, MD, United States</i>
		083	Statistical Issues of Bridging Single-Race and Multiple-Race Reports in the Population Data <i>M. Yu, National Cancer Institute, Rockville, MD, United States</i>
		084	Clarifying Race Reporting in New Jersey <i>L. Paddock, New Jersey State Cancer Registry, Trenton, NJ, United States / Rutgers School of Public Health, Piscataway, NJ, United States</i>

PROGRAM + AGENDA

THURSDAY, JUNE 18 | AFTERNOON

TIME	LOCATION	EVENT
1:00pm-2:30pm	CONCURRENT SESSION 5 Continued	
Section B: Launching a New Era of Standards and Automation <i>Moderator:</i> <i>Lori Havener</i>	Grand Ballroom B - Level 2	085 Automating the Multiple Primary Rules <i>P. Ransdell, Kentucky Cancer Registry, Lexington, KY, United States</i>
		086 Real Time Discrete Data Elements from Synoptic Radiology Reports to Enhance Cancer Registry Operations <i>G. Lee, Cancer Care Ontario, Toronto, ON, Canada</i>
		087 Comparing a Standard (NAACCR Volume V) with a Draft Standard (HL7 Version 2.5.1 Implementation Guide: ELR Reporting to Public Health, Release 2) <i>J.N. Harrison, New York State Cancer Registry, Menands, NY, United States</i>
		088 Use of Integrating the Healthcare Enterprise (IHE) Standardized Data Capture (SDC) Content Profile to Exchange Standardized Data Between Clinical Care and Cancer Registries <i>S. Jones, Centers for Disease Control and Prevention, Atlanta, GA, United States</i>
Section C: Cancer Clusters and Analytic Tools <i>Moderator:</i> <i>Bruce Riddle</i>	Tryon Room - Level 2	089 Lung Cancer Incidence in a Rural Montana County Undergoing Asbestos Screening, 2000-2008 <i>L. Williamson, Montana Department of Public Health and Human Services, Helena, MT, United States</i>
		090 Investigation of a Possible Link between Pollution from WWII Military Facilities and Cancer in Yakutat, Alaska <i>D.K. O'Brien, Alaska Cancer Registry, Anchorage, AK, United States</i>
		091 Confidence Intervals for Rate Ratios Between Geographic Units <i>L. Zhu, National Cancer Institute, Rockville, MD, United States</i>
		092 Model-Based Small Area Estimation for Cancer Screening and Smoking Related Behaviors <i>B. Liu, National Cancer Institute, Rockville, MD, United States</i>
Section D: Moving Toward Improved Surveillance of Treatment and Outcomes <i>Moderator:</i> <i>Amanda Shaw</i>	Harris Room - Level 2	093 Nonclinical Factors Associated with Premature Termination of Adjuvant Chemotherapy for Stage I-III Breast Cancer <i>X. Wu, LSU Health Sciences Center, New Orleans, LA, United States</i>
		094 The Effect of Comorbidity on the Use of Adjuvant Chemotherapy and Type of Regimen for Resected Stage III Colon Cancer Patients <i>M.C. Hsieh, Louisiana Tumor Registry and Epidemiology Program, School of Public Health, LSU Health Sciences Center, New Orleans, LA, United States</i>
		095 "First in Flight" or "When Pigs Fly" – Can Cancer Registries Play a Critical Role at the National Level in Studying Cancer as an Adverse Outcome from Drug Treatments? <i>K. Midkiff, RTI Health Solutions, Research Triangle Park, NC, United States</i>
		096 Long-term Cancer Surveillance: Five-Year Update for the Forteo Patient Registry Data Linkage Study <i>D. Harris, RTI Health Solutions, Research Triangle Park, NC, United States</i>
2:30pm-3:00pm	Stonewall Promenade - Level 2	Afternoon Break

THURSDAY, JUNE 18 | AFTERNOON

TIME	LOCATION	EVENT
3:00pm-4:00pm	Providence Ballroom - Lobby Level	CLOSING PLENARY SESSION 4 Intersection of Public Health Surveillance and Clinical Medicine <i>Moderator:</i> <i>Jill MacKinnon</i>
		3:00pm-3:30pm Electronic Health Records: The Intersection of Public Health Surveillance and Clinical Medicine <i>Lisa Richardson, MD, MPH, Director, CDC Division of Cancer Prevention and Control, Centers for Disease Control and Prevention</i> 3:30pm-4:00pm Leveraging State Cancer Registries to Measure and Improve Quality of Cancer Care <i>Dennis Deapen, DrPH, Director, Los Angeles Cancer Surveillance Program, University of Southern California</i>
4:00pm-4:15pm	Providence Ballroom - Lobby Level	Invitation to 2016 Meeting - St. Louis, Missouri <i>Jeannette Jackson-Thompson, PhD</i>
4:15pm-4:30pm	Providence Ballroom - Lobby Level	Closing Remarks and Adjournment
4:30 pm	Providence Ballroom - Lobby Level	Conference Closes





PROGRAM-AT-A-GLANCE

TIME	MONDAY, JUNE 15	TUESDAY, JUNE 16	WEDNESDAY, JUNE 17	THURSDAY, JUNE 18	TIME
6:30 am	COMMUNICATIONS STEERING COMMITTEE MEETING Communications Priority Area Network Meeting (Tyron Room, Level 2; 9:00 am - 10:30 am)	NAACCR ROUNDTABLE (Grand Ballroom A, Level 2; 7:00 am - 8:00 am)	BIRDS OF A FEATHER ROUNDTABLE (Grand Ballroom A, Level 2; 7:00 am - 8:00 am)	NAACCR 2015 5K RUN/WALK (Meet in Hotel Lobby; 6:30 am)	6:30 am
7:00					7:00
7:30					7:30
8:00					8:00
8:30	PROFESSIONAL DEVELOPMENT STEERING COMMITTEE Professional Development Priority Area Network Meeting (Independence Room, Level 2; 9:00 am - 10:30 am)	KEYNOTE ADDRESS (Providence Ballroom, Lobby Level; 8:30 am - 10:00 am)	PLENARY SESSION 2 Big Data! (Providence Ballroom, Lobby Level; 8:30 am - 9:45 am)	CONCURRENT SESSION 4 (Various Rooms; 8:00 am - 9:30 am)	8:30
8:45					8:45
9:00					9:00
9:30					9:30
10:00	UNIFORM DATA STANDARDS (Harris Room, Level 2; 10:00 am - 11:00 am)	BREAK/POSTER VIEWING/EXHIBITS (Grand Ballroom C/D, Level 2; 10:00 am - 10:30 am)	BREAK/POSTER VIEWING/EXHIBITS (Grand Ballroom C/D, Level 2; 9:45 am - 10:00 am)	BREAK (Grand Ballroom C/D, Level 2; 9:30 am - 10:00 am)	10:00
10:15				NEXUS TABLET DRAWING	10:15
10:30				PLENARY SESSION 3 Launching a New Era in Registry Operations (Providence Ballroom, Lobby Level; 10:00 am - 11:30 am)	10:30
10:45					10:45
11:00	RESEARCH & DATA USE STEERING COMMITTEE MEETING Research & Data Use Priority Area Network Meeting (Sharon Room, Level 2; 10:30 am - 12:00 pm)	PLENARY SESSION 1 Launching a New Era in Research - Applications for Cancer Registries (Providence Ballroom, Lobby Level; 10:30 am - 12:30 pm)	CONCURRENT SESSION 3 (Various Rooms; 10:00 am - 11:30 am)	LUNCH ON YOUR OWN (11:30 am - 1:00 pm)	11:00
11:30					11:30
12:00 pm					12:00 pm
12:30					12:30
1:00	BOARD/CHAIR TRAINING (Independence Room, Level 2; 12:00 pm - 2:00 pm)	LUNCH/POSTER VIEWING/EXHIBITS (Grand Ballroom C/D, Level 2; 12:30 pm - 1:30 pm)	LUNCHEON & AWARDS CEREMONY (Providence Ballroom, Lobby Level; 11:45 am - 1:00 pm)	CONCURRENT SESSION 5 (Various Rooms; 1:00 pm - 2:30 pm)	1:00
1:30					1:30
1:45					1:45
2:00					2:00
2:30	STANDARDIZATION & REGISTRY STEERING COMMITTEE (Harris Room, Level 2; 2:00 pm - 3:30 pm)	CONCURRENT SESSION 1 (Various Rooms; 1:30 pm - 3:00 pm)	NAACCR BUSINESS MEETING (Providence Ballroom, Lobby Level; 1:00 pm - 2:30 pm)	BREAK (Stonewall Promenade; 2:30 pm - 3:00 pm)	2:30
3:00					3:00
3:15					3:15
3:30					3:30
3:45	STANDARDIZATION & REGISTRY PRIORITY AREA NETWORK MEETING (Harris Room, Level 2; 3:30 pm - 4:30 pm)	CONCURRENT SESSION 2 (Various Rooms; 3:30 pm - 5:00 pm)	THE FORDS REVISION PROJECT (Providence Ballroom, Lobby Level; 2:30 pm - 3:45 pm)	CLOSING PLENARY SESSION 4 Intersection of Public Health Surveillance and Clinical Medicine (Providence Ballroom, Lobby Level; 3:00 pm - 4:00 pm)	3:45
4:00					4:00
4:30					4:30
5:00					5:00
5:30	Exhibitor Showcase and Poster Pre-Viewing (Grand Ballroom C/D, Level 2; 5:30 pm - 7:00 pm)	REGISTRY OF THE FUTURE OPEN FORUM Operations Section (Grand Ballroom A, Level 2; 5:15 pm - 6:15 pm) Research Section (Grand Ballroom B, Level 2; 5:15 pm - 6:15 pm)	NAACCR BIKE EVENT (Meet in Hotel Lobby, begins at 4:00 pm)	CLOSING REMARKS & ADJOURNMENT	5:30
6:00					6:00
6:30					6:30
7:00					7:00
	GSADD Workgroup Meet in Lobby for Dinner (7:00 pm)	OPENING RECEPTION (Providence Ballroom, Lobby Level; 6:30 pm - 9:00 pm)			

Plenary Sessions

Concurrent Sessions

Committee Meetings

Other Sessions

Break/Lunch

Awards Luncheon