



FINAL PROGRAM
GATEWAY TO CANCER DISCOVERIES

NAACCR 2016 Annual Conference



June 11 - 16, 2016
St. Louis, Missouri
Hyatt Regency
St. Louis at The Arch

NAACCR 2016 Exhibitors & Sponsors

CONFERENCE SPONSOR

NOVO NORDISK



100 College Road West
Princeton, NJ 08540
☎ 215.390-1395
📧 Dr. Kelly Davis of UBS
✉ kelly.davis@unitedbiosource.com

BRONZE SPONSOR & CONFERENCE EXHIBITOR

MISSOURI CANCER REGISTRY AND RESEARCH CENTER (MCR-ARC)



401 Clark Hall
Columbia, MO 65211-4380
☎ 573.882.7775
📧 Jeannette Jackson-Thompson
✉ Jacksonthompsonj@health.missouri.edu

This project was supported in part by a cooperative agreement between the Centers for Disease Control and Prevention (CDC) and the Missouri Department of Health and Senior Services (DHSS) (#U58/DP003924-04) and a Surveillance Contract between DHSS and the University of Missouri.

Grant Information



This program is supported in part by NCI Contract Number HHSN261201400004I and Conference Grant IR13CA206374 from the National Cancer Institute and CDC Cooperative Agreement Number 5U58DP004917 from the Centers for Disease Control and Prevention. Its contents are solely the responsibility of the authors and do not necessarily represent the official views of the National Cancer Institute or the Centers for Disease Control and Prevention. Without their support, this scientific conference would not be possible.

Images Copyright © St. Louis Convention & Visitors Commission. All Rights Reserved.

CONFERENCE EXHIBITORS

AMERICAN CANCER SOCIETY



250 Williams Street NW
Atlanta, GA 30303
☎ 404.329.7992
📧 Rebecca Siegel
✉ rebecca.siegel@cancer.org

ARTIFICIAL INTELLIGENCE IN MEDICINE INC.



2 Berkeley Street, Suite 403
Toronto, ON M5A 2W3
Canada
☎ 866.645.2224
📧 Elaine Cooke
✉ ecooke@aim.ca

ELEKTA



400 Perimeter Center Terrace, Suite 50
Atlanta, GA 30346
☎ 770.670.2374
📧 Lori Minton
✉ Lori.Minton@Elekta.com

HEALTH LANGUAGE ANALYTICS GLOBAL



International Business Centre
2 Cornwallis Street
Eveleigh, NSW Australia 2015
☎ 61.4.2571.8996
📧 Maryellen Galbally
✉ maiellen@iinet.net.au

ICF INTERNATIONAL



9300 Lee Highway
Fairfax, VA 22031
☎ 301.407.6756
Ⓜ Chris Bishop
✉ Chris.Bishop@icfi.com

IMS, INC



Information Management Services, Inc.

3901 Calverton Boulevard, Suite 200
Calverton, MD 20705
☎ 301.680.9770
Ⓜ David Annett
✉ annettd@imsweb.com

INSTANTATLAS - GEOWISE LIMITED



Holyrood Park House
106 Holyrood Road
Edinburgh, Scotland, UK EH8 8AS
☎ 1.800.961.8948
Ⓜ John E A Bartholomew
✉ john.bartholomew@instantatlas.com

KENTUCKY CANCER REGISTRY

2365 Harrodsburg Road, Suite A230
Lexington, KY 40504
☎ 859.218.3188
Ⓜ Chaney Blu
✉ chaney@kcr.uky.edu

NAACCR



2050 W. Iles Avenue, Suite A
Springfield, IL 62704
☎ 217.698.0800 X 1
Ⓜ Monica Thornton
✉ mthornton@NAACCR.org

NATIONAL CANCER REGISTRARS ASSOCIATION



1330 Braddock Place, Suite 520
Alexandria, VA 22314
☎ 703.299.6640
Ⓜ Paula Spitler
✉ pspitler@ncra-usa.org

NEW MEXICO TUMOR REGISTRY



UNM | HEALTH SCIENCES CENTER

UNM HSC
MSC11-6020
1 University of New Mexico
Albuquerque, NM 87131
☎ 505.272.5541
Ⓜ Ginger Williams
✉ vwilliam@nmtr.unm.edu

REGISTRY PARTNERS



2607-D Holly Hill Street
Burlington, NC 27215
☎ 336.226.3359
Ⓜ Katie Mears
✉ katiemears@registrypartners.com

RTI HEALTH SOLUTIONS

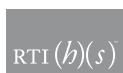

3040 E. Cornwallis Road
Research Triangle Park, NC 27709
☎ 919.541.7383
Ⓜ Margo Jordan
✉ mjordan@rti.org

WESTAT



1600 Research Boulevard
Rockville, MD 20850
☎ 301.251.4259
Ⓜ Kelly Kennedy
✉ KellyKennedy@westat.com



Exhibitors & Sponsors NAACCR 2016



June 11-16, 2016
St. Louis, MO

Gateway to Cancer
Discoveries

NAACCR 2016 Welcome

Dear friends and colleagues,

On behalf of the Board of Directors and Planning Committee, it is my pleasure to welcome you to St. Louis, Missouri – the Gateway City – and to the 2016 Annual Conference of the North American Association of Central Cancer Registries, Inc. (NAACCR).

This year's conference theme is "Gateway to Cancer Discoveries," with the goal of highlighting the ever-changing landscape of cancer surveillance and research activities while simultaneously exploring new directions and opportunities that enhance cancer surveillance. Plenary themes for this year are: "Gateway to Implementation and Results," "Gateway to Diversity," "Gateway to Information" and "Gateway to Scientific Discovery" as well as "Gateway to Patient Centeredness and Patient Perspectives."

The keynote address will focus on strategies for accelerating translation of research findings into cancer prevention that works. Plenary sessions will cover a wide range of topics, such as lung cancer screening guidelines and the impact on surveillance; diversity (American Indian and tribal populations; lesbian, gay, bi, and transgender populations); natural language processing – information to data; CDC perspective on the future of cancer surveillance; and how population-based cancer data influences palliative care and end-of-life decision-making.

The 2016 Conference is being held at the Hyatt Regency St. Louis at The Arch, situated on the St. Louis riverfront (the "Mighty Mississippi") and a short (7-10 minute) stroll to the iconic Gateway Arch, the Old Courthouse, the Old Cathedral (Basilica of St. Louis, King of France), Busch Stadium – home of the St. Louis Cardinals – and Ballpark Village. Other well-known attractions accessible by public transportation (MetroLink and MetroBus) include Forest Park (Saint Louis Art Museum, Missouri History Museum, Saint Louis Zoo), the Missouri Botanical Gardens ("Shaw's Garden" to locals), the spectacular Cathedral Basilica of St. Louis, and the historic Anheuser-Busch Brewery. In addition, a host of dining and entertainment venues are available in and around the hotel and further afield in one of St. Louis' historic neighborhoods – the chic Central West End, Soulard (oldest neighborhood), the Hill (Italian), Delmar Loop ("One of the 10 Great Streets in America"; Chuck Berry still performs at Blueberry Hill) and Downtown West, location of the National Historic Landmark St. Louis Union Station.

We would like to express our thanks to Venue West Conference Services for their excellent arrangements in all aspects of the Conference, to the dedicated NAACCR staff, as well as to colleagues and various organizers for their untiring help, support and advice in planning and arranging this meeting.

We hope that you enjoy the Conference and that your interaction with colleagues from many states, provinces, and territories will stimulate a creative exchange of ideas and will be personally rewarding. We also hope and trust that you will enjoy your visit to the exciting city of St. Louis and all it has to offer!

See you in St. Louis!

Jeannette Jackson-Thompson, MSPH, PhD
Chair, 2016 NAACCR Conference

Welcome to the 2016 NAACCR Annual Conference!

Let me begin by offering a hearty and well-deserved thank you to Dr. Jeannette Jackson-Thompson, her colleagues at the Missouri Cancer Registry and Research Center, and members of the 2016 NAACCR Annual Conference Program Committee for assembling a stellar agenda for this meeting.

As we planned this event over the past year, I was impressed with Dr. Jackson-Thompson's persistent efforts to make this Annual Conference a welcoming venue for students and junior investigators. Jeannette achieved her goal, as she usually does. The pre-conference workshop, *Introduction to Cancer Surveillance Workshop for Students and Junior Investigators*, will provide an opportunity to learn the nuts and bolts of cancer surveillance. This workshop will prepare students and other participants to more fully appreciate sessions that they will attend during the regular meeting. If you're a student, junior investigator, or are otherwise new to the organization, your experience here will also benefit from meeting and talking with others who are involved in this important work. Don't hesitate to introduce yourself to NAACCR members and ask lots of questions. If you're a seasoned member of NAACCR, take time to talk with students, junior investigators, and those new to the field and freely share your knowledge and expertise.

I encourage you to read through this program prior to the meeting. You'll find a rich - sometimes overwhelming - assortment of presentations relevant to cancer surveillance in the current era, including - but certainly not limited to - cancer in diverse populations, uses of information technology, and statistical and research methodologies. It may be a good idea to identify and prioritize those sessions of greatest interest to you so that you don't overlook something.

In my estimation, annual in-person meetings are more important than ever. I greatly appreciate the many benefits that my gadgets and information technology bring to the workplace. Nonetheless, I have never had a virtual encounter that came close to face-to-face engagement with my NAACCR friends and colleagues.

I encourage you to fully and actively participate in this meeting. Also take advantage of the many meeting-related events, including the reception, walks, bike tour, and professional baseball game. Also be sure to leave the hotel and experience this marvelous city. Go ahead and use your i-Thing to locate some interesting destinations, then stow that gadget and get out to sample the rich array of sights, sounds, smells, tastes, and feel of St. Louis.



Chuck Wiggins, PhD
President, NAACCR

NAACCR 2016 Welcome from the President

NAACCR 2016 Board Members



Charles Wiggins, PhD
(2015-2017)
NAACCR President
New Mexico Tumor Registry
☎ 505.272.8594
✉ cwiggins@salud.unm.edu



Past-President
Jill A. MacKinnon, PhD, CTR (2015-2016)
Florida
☎ 305.243.3426
✉ jill_mackinnon@miami.edu



Treasurer
Bruce L. Riddle (2015-2017)
New Hampshire State Cancer Registry
☎ 603.653.6620
✉ bruce.l.riddle@dartmouth.edu



Ex-Officio
Betsy A. Kohler, MPH, CTR
NAACCR, Inc.
☎ 217.698.0800 ext. 2
✉ bkohler@naacccr.org

Representative, Sponsoring Member Organizations



Lori Swain (2014-2016)
National Cancer Registrars Association
☎ 703.299.6640 (313)
✉ lswain@ncra-usa.org

Representatives-at-Large



Christopher Johnson, MPH (2014-2016)
Cancer Data Registry of Idaho
☎ 208.489.1380
✉ cjohnson@teamiha.org



Deirdre Rogers, MS, CTR (2015-2017)
Mississippi Cancer Registry
☎ 601.815.5479
✉ dbrogers@umc.edu



Eric B. Durbin, DrPH, MS (2013-2017)
Kentucky Cancer Registry
☎ 859.218.3179
✉ ericd@kcr.uky.edu



Francis P. Boscoe, PhD (2014-2016)
New York State Cancer Registry
☎ 518.474.2255
✉ fpb01@health.state.ny.us



Kim Vriends, BHA, CHIM (2012-2016)
Prince Edward Island Cancer Registry
☎ 902.894.2167
✉ kavriends@gov.pe.ca



Winny Roshala, BA, CTR (2013-2017)
Cancer Registry of Greater California
☎ 916.779.0313
✉ wroshala@crgc-cancer.org

Sponsors and Partners in Cancer Surveillance

Canadian Partnership Against Cancer
Centers for Disease Control and Prevention
National Cancer Institute
National Cancer Registrars Association
Public Health Agency of Canada
American Cancer Society
American College of Surgeons
American Joint Committee on Cancer

This year's conference theme is "Gateway to Cancer Discoveries." Attendees will explore how data collected on virtually all cancer cases in North America form the basis for improving our understanding of cancer on every level. The keynote presentation will focus on strategies to accelerate translating research findings into cancer-prevention actions that work and are critical to improving patient health. Plenary sessions build on the gateway theme: Gateway to Results; ... to Implementation; ... to Diversity; ... to Information; ... to Scientific Discovery; and ... to Patient Centeredness and Patient Perspectives. The goal is to present multiple perspectives on cancer surveillance in North America and address potential future needs and directions.

2016 NAACCR Annual Conference Program Committee Members

Thanks to all the members of the 2016 Program Committee for their time and guidance in planning the 2016 conference!

Name

Jeannette Jackson-Thompson, Chair

Sharon (Shari) Ackerman

Frances (Fran) Babcock

Charlie Blackburn

Mignon Dryden

Brenda K. Edwards

Susan T. Gershman

Jim Hofferkamp

Annette Hurlbut

Lori Koch

Betsy Kohler

Kimberly Johnson

Nancy Lozon

Jill Mackinnon

Sarah Manson

Angela Martin

Howard (Jim) Martin

Lynne Penberthy

Rich Pinder

Antoinette (Nan) Stroup

Kathleen Thoburn

Monica Thornton

Hannah Weir

Charles (Chuck) Wiggins

Virginia (Ginger) Williams

Affiliation

Missouri Cancer Registry and Research Center/
University of Missouri School of Medicine

Missouri Cancer Registry and Research Center/
University of Missouri School of Medicine

Centers for Disease Control and Prevention (NPCR)
NAACCR, Inc.

Cancer Registry of Greater California

National Cancer Institute

Massachusetts Cancer Registry

NAACCR, Inc.

Elekta

Illinois State Cancer Registry

NAACCR, Inc.

Washington University in St. Louis

Metropolitan Detroit Cancer Surveillance System

Consultant for Florida Cancer Data System

Centers for Disease Control and Prevention (NPCR)

NAACCR, Inc.

Virginia Cancer Registry

National Cancer Institute

Los Angeles Cancer Surveillance Program

New Jersey State Cancer Registry

Commission on Cancer

NAACCR, Inc.

Centers for Disease Control and Prevention (NPCR)

New Mexico Tumor Registry

New Mexico Tumor Registry

NAACCR 2016 Committee & Theme

CONFERENCE REGISTRATION INFORMATION

The Conference Registration and Information Desk is located outside the Grand Ballroom ABCD on Level 4 and is open during the following days and times:

Monday, June 13	9:00 am to 7:00 pm
Tuesday, June 14	7:00 am to 5:00 pm
Wednesday, June 15	7:30 am to 11:45 am
Thursday, June 16	7:00 am to 11:30 am

Pre-Conference registration and check-in desks are located outside the Pre-Conference rooms.

Any inquiries about the conference, social functions, etc., may be answered by any of the staff at the registration desk. Registered participants will receive their conference documents and badges at the registration desk. Please note that entrance to the Reception and Awards Luncheon is by ticket only. Please be sure you wear your name badge to all social events, workshops, and sessions.



St. Louis Cardinals Game

Take advantage of the short stroll to Busch Stadium and our special NAACCR rate, and watch as the St. Louis Cardinals take on the Houston Astros on **Wednesday, June 15!** Game begins at 6:15 pm. NAACCR block tickets needed to purchased prior to the conference. Check ticket availability via St. Louis Cardinals website.

NAACCR 2016 Conference Information

SESSIONS / BUSINESS MEETING

All Plenary Sessions, Concurrent Sessions, and the Business Meeting will take place on Level 2 and Level 4. The Plenary Sessions and the Business Meeting will be held in the Grand Ballroom ABCD on the Level 4.

OPENING RECEPTION

Tuesday, June 14, 2016

The Opening Reception will be held in the Gateway East and Gateway Terrace on Level 18 from 6:45 pm. It serves as the perfect gathering place to enjoy networking, fabulous foods, and some unique entertainment.

CONTINUING EDUCATION CREDITS

Continuing Education credit is provided by the National Cancer Registrars Association (NCRA). You will be able to conveniently download the 2016 NAACCR Annual Conference CE Hours Form from the NAACCR website at www.naacccr.org/educationandtraining/annualconference.aspx.

EXHIBITS AND POSTER INFORMATION

Exhibits and Posters will be located in Grand Ballroom EFGH on Level 4.

All delegates are encouraged to take the opportunity to visit the exhibits and posters to become familiar with some of the latest advances and research in the field.

They will be available at these times:

Exhibit Hours

Monday, June 13	5:30 pm to 7:00 pm
Tuesday, June 14	7:00 am to 5:45 pm
Wednesday, June 15	7:00 am to 12:00 pm
Thursday, June 16	7:00 am to 3:30 pm

CYBER CAFÉ

The Cyber Café is located within the Exhibit area and can be accessed during exhibition hours.

CONFERENCE EVALUATIONS

2016 conference evaluations will be available in electronic format only.

Please visit:

www.naacccr.org/educationandtraining/annualconference.aspx to complete your evaluation. All delegates will be emailed reminders and links to the evaluation forms after the conference.

SECOND FLOOR

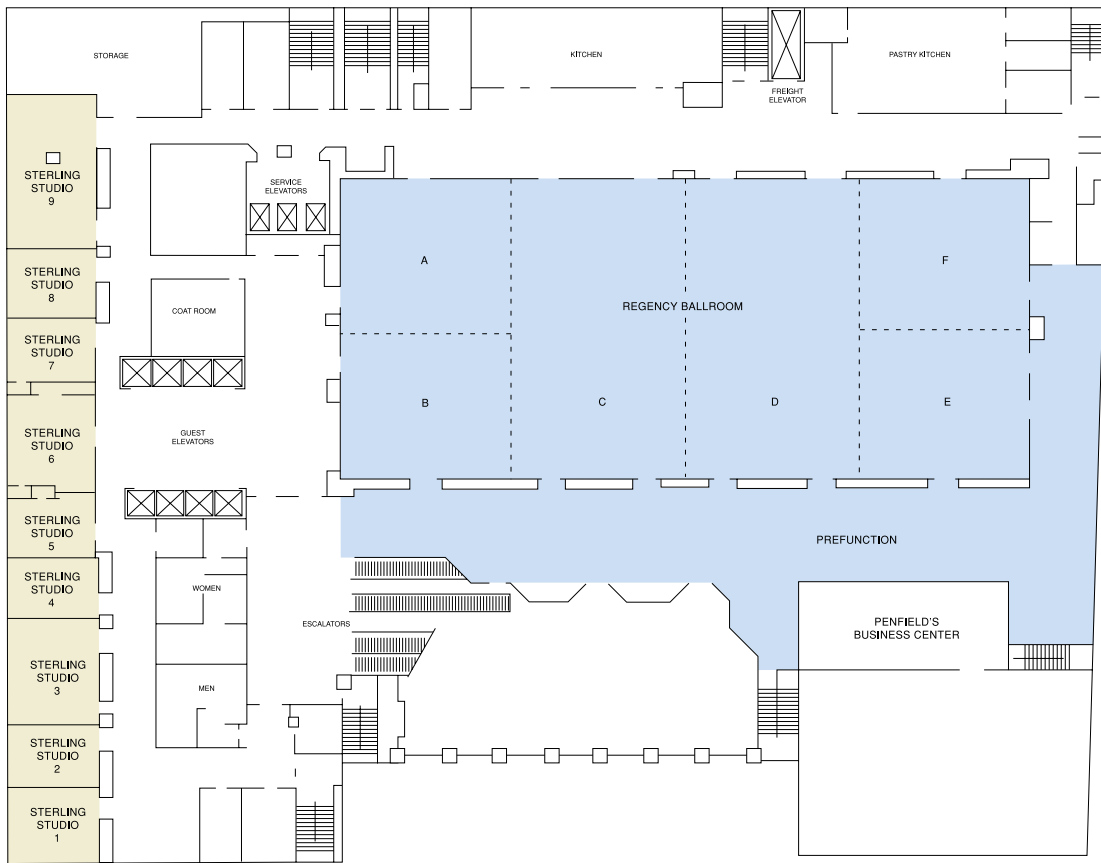

FOURTH FLOOR

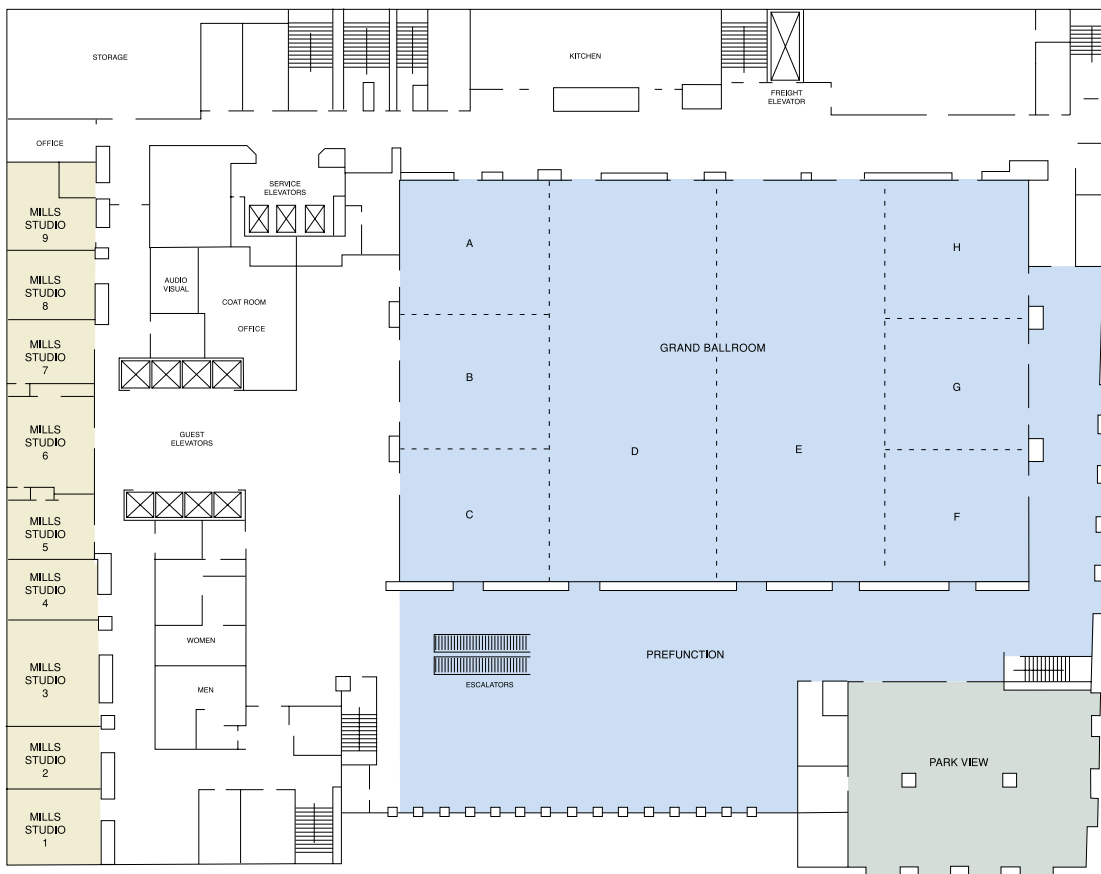

NAACCR 2016 Hotel Floor Plans

Saturday, June 11

PRE-CONFERENCE

8:30am - 5:30pm	Mills 3	Workshop: Basic SEER*Stat Software Training <i>Course Organizer: Dr. Angela Mariotto</i>
-----------------	---------	--

Sunday, June 12

PRE-CONFERENCE

8:00am - 5:00pm	Park View	Board of Directors Meeting
8:30am - 5:30pm	Mills 3	Workshop: Advanced SEER*Stat Software Training <i>Course Organizer: Dr. Angela Mariotto</i>
10:00am - 5:30pm	Mills 1	Workshop: Researcher Toolkit Pre-Conference Training <i>Course Organizer: Recinda Sherman, PhD</i>

Monday, June 13

PRE-CONFERENCE

7:00am - 9:00am	Park View	Board of Directors Meeting - Day 2 (if required)
8:30am - 4:30pm	Mills 3	Workshop: "How Did You Get My Name?!": Conducting Survey Research in Central Cancer Registries and Optimizing Recruitment <i>Course Organizer: Antoinette Stroup, PhD</i>
9:00am - 4:30pm	Mills 1	Workshop: Introduction to Cancer Surveillance Workshop for Students and Junior Investigators <i>Course Organizer: Jeannette Jackson-Thompson, PhD and Kimberly Johnson, PhD, MPH</i>
9:00am - 7:00pm	Prefunction – Fourth Floor	Conference Registration Check-In
10:30am - 12:00pm	Park View	NAACCR Board/Chair Meeting
12:00pm - 1:00pm	Mills 8	Communications Steering Committee Meeting Communications Priority Area Network Meeting (All welcome to attend PAN Meeting)
1:00pm - 2:30pm	Sterling 9	Standardization and Registry Development Steering Committee Meeting
1:00pm - 5:00pm	Grand Ballroom EFGH	Exhibitor and Poster Set-up
2:30pm - 4:00pm	Mills 8	Research and Data Use Steering Committee Meeting Research and Data Use Priority Area Network Meeting (All welcome to attend PAN meeting)
4:00pm - 5:00pm	Sterling 9	Professional Development Steering Committee Meeting Professional Development Priority Area Network Committee Meeting (All welcome to attend PAN meeting)
4:00pm - 5:00pm	Park View	XML Task Force
5:00pm - 6:00pm	Mills 8	NAACCR Sponsoring Member Organization Meeting (Invitation Only)
5:30pm - 7:00pm	Grand Ballroom EFGH	Exhibitor Showcase and Poster Previewing Join us in the exhibit hall to visit with the conference exhibitors, preview scientific posters and meet friends before you head out for dinner in St. Louis. Cash bar and complimentary light appetizers will be available.
6:00pm	Meet in lobby (location of dinner tbd)	Geographic, Spatial and Demographic Data (GSADD) Workgroup Dinner Are you interested in GIS, area-based analysis, or geospatial epidemiology? Please join like-minded folks from the Geography, Spatial and Demography Data (GSADD) group for a no-host dinner. We are guaranteed to be lively and possibly even productive.
6:30pm - 7:00pm	Grand Ballroom EFGH	Program Committee Reception Program Committee members please meet in the designated area of the exhibit hall.

Tuesday, June 14

6:30am - 8:00am	Grand Ballroom EFGH	Breakfast	
6:30am - 8:00am	Grand Ballroom EFGH Designated Area in Ballroom	Meet NAACCR Board Members, NAACCR Staff and Other NAACCR Members Learn more about how to become involved. Ask questions. Be sure to bring your breakfast into this casual session.	
7:00am - 5:00pm	Prefunction – Fourth Floor	Conference Registration Check In	
7:00am - 5:45pm	Grand Ballroom EFGH	Exhibit Hall Open	
7:00am - 5:00pm	Grand Ballroom EFGH	Poster Viewing	
8:00am - 8:30am	Grand Ballroom ABCD	Opening Ceremonies and Welcome <i>Moderators: Jeannette Jackson-Thompson and Chuck Wiggins</i>	
8:30am - 9:30am	GATEWAY TO CANCER DISCOVERIES KEYNOTE ADDRESS		
8:30am - 9:15 am <i>Moderator: Chuck Wiggins</i>	Grand Ballroom ABCD	Strategies for Accelerating Translation of Research Findings into Cancer Prevention that Works <i>Graham Colditz, DrPH, MD, MPH, Niess-Gain Professor of Surgery, School of Medicine; Associate Director of Prevention and Control, Siteman Cancer Center; and Deputy Director, Institute for Public Health, Washington University in St. Louis</i>	
9:15am - 9:30am	Grand Ballroom ABCD	Questions and Discussion	
9:30am - 10:00am	Grand Ballroom EFGH	Morning Break, Exhibits, and Poster Viewing	
10:00am - 12:00pm	Plenary Session 1		
Gateway to Implementation and Results <i>Moderator: Linda Corrigan</i>	Grand Ballroom ABCD	10:00am - 10:30am	Lung Cancer Screening Guidelines and the Impact on Cancer Surveillance <i>Michael LeFevre, MD, MSPH, Co-Vice Chair, U.S. Preventive Services Task Force on Lung Cancer Screening Guidelines/Vice Chair, Family & Community Medicine, University of Missouri School of Medicine</i>
		10:30am - 11:00am	Recording Pediatric Cancer Stage in Population-Based Cancer Registries: The Toronto Consensus Guidelines <i>A. Lindsay Frazier, MD, Associate Professor of Pediatrics, Harvard Medical School Dana-Farber Cancer Institute</i>
		11:00am - 11:30am	The Camp Lejeune Cancer Incidence Study: The Need for Nationwide Cancer Data <i>Frank Bove, ScD, Senior Epidemiologist, Agency for Toxic Substances and Disease Registry, CDC</i>
		11:30am - 12:00pm	Questions and Discussion
12:00pm - 1:15pm	Grand Ballroom EFGH	Lunch on Your Own, Exhibits, and Poster Viewing	
12:00pm - 1:15pm	Gateway East, Level 18	MTC Registry Luncheon - Invited Meeting	

1:15pm - 3:30pm		Plenary Session 2	
Gateway to Diversity <i>Moderator: Jeannette Jackson-Thompson</i>	Grand Ballroom ABCD	1:15pm - 1:30pm	Setting the Stage for Diversity <i>Panel Moderator: Diane L. Adams, MD, MPH, DABCHS, CHS-III, Juxtopia, LLC</i>
		1:30pm - 1:45pm	Cancer and Mortality Surveillance for American Indian and Alaska Native Populations <i>Melissa A. Jim, MPH, CDC, Indian Health Service</i>
		1:45pm - 2:00pm	If You Don't Ask, You Don't Count: Including Sexual Orientation and Gender Identity for Cancer Research and Surveillance <i>Jane A. McElroy, PhD, Associate Professor, Family and Community Medicine, University of Missouri School of Medicine</i>
		2:00pm - 2:15pm	Training for Diversity in Public Health Practice <i>Ross C. Brownson, PhD, George Warren Brown School of Social Work, Washington University in St. Louis/President, American College of Epidemiology</i>
		2:15pm - 2:30pm	Questions and Discussion
NAACCR News	Grand Ballroom ABCD	2:30pm - 3:30pm	Update on the NAACCR Strategic Management Plan 2016-2021 <i>Antoinette Stroup, PhD, NAACCR President-Elect</i>
			Virtual Pooled Registry Project <i>Castine Clerkin, MS, CTR, NAACCR Program Manager of Virtual Pooled Registry</i>
3:30pm - 4:00pm	Grand Ballroom EFGH	Afternoon Break, Exhibits, and Poster Viewing	
4:00pm - 5:30pm	Concurrent Session 1		
A Gateway to Molecular Epidemiology: Breast Cancer <i>Moderator: Fran Babcock</i>	Park View	01 Triple Negative Breast Cancer and Factors Associated with Its Treatment in the U.S., 2011–2012 <i>M. Wu, CDC, Atlanta, GA, United States</i>	
		02 Triple-Negative Breast Cancer in Georgia: Burden, Disparities, and Connections to Georgia's Breast Cancer Genomics Program <i>A.K. Berzen, Georgia Department of Public Health, Atlanta, GA, United States</i>	
		03 Breast Cancer Incidence in Marin County: A Hotspot Grows Cold? <i>C. Clarke-Dur, Cancer Prevention Institute of California, Fremont, CA, United States</i>	
		04 Utilization of Oncotype DX Test for Node-Negative, Hormone Receptor Positive, HER2 Negative Breast Cancers in the Community Setting <i>X.C. Wu, LSU Health Sciences Center, New Orleans, LA, United States</i>	
B Gateway to Cancer Epidemiology I <i>Moderator: Sue-Min Lai</i>	Regency B	05 Hispanic Childhood Leukemia Incidence in California: High and Rising <i>B. Giddings, California Cancer Reporting and Epidemiologic Surveillance Program, UC Davis Health System, Institute for Population Health Improvement, Sacramento, CA, United States</i>	
		06 On Second Thought, Yes, We Do Have a Prevalence Estimate for Non-Malignant Brain Tumors! <i>C. Kruchko, Central Brain Tumor Registry of the United States (CBTRUS), Hinsdale, IL, United States</i>	
		07 Trends in the Lifetime Risk of Developing Cancer in Ontario, Canada <i>H. Jiang, Cancer Care Ontario, Toronto, ON, Canada University of Toronto, Toronto, ON, Canada</i>	
		08 Completeness of Required Site-Specific Factors for Brain and CNS Tumors in the Surveillance, Epidemiology and End Results (SEER) 18 Database (2004-2012, Varying) <i>J.S. Barmholtz-Sloan, Central Brain Tumor Registry of the United States (CBTRUS), Hinsdale, IL, United States Case Comprehensive Cancer Center, Case Western Reserve University School of Medicine, Cleveland, OH, United States</i>	

Tuesday, June 14

4:00pm - 5:30pm Concurrent Session 1 Continued		
C Gateway to Enhanced Data Processing Moderator: Kathleen Thoburn	Regency A	09 Using NAACCR XML with Relational Databases <i>I. Hands, Kentucky Cancer Registry, Lexington, KY, United States</i>
		10 NAACCR XML in Action: from the SEER Abstracting Tool to SEER*DMS <i>F. Depry, Information Management Services, Inc., Calverton, MD, United States</i>
		11 How Bridging the Gap between VB6 and .Net Provides Efficiency for Automated Tumor Linkage Procedures in Registry Plus Central Registry Database Software <i>M. Esterly, CDC/NPCR, Atlanta, GA, United States</i>
		12 Florida Physician Claims Processing: From Collection to Implementation <i>G. Levin, Florida Cancer Data System, Miami, FL, United States</i>
		13 Unlocking the Power of Physician Medical Claims <i>M. Hernandez, Florida Cancer Data System, University of Miami, Miami, FL, United States</i>
D Gateway to Improved Data through Linkage Moderator: Heather Stuart-Panko	Regency C	14 Assessment of Linkage of SEER Breast Cancer Cases to Oncotype DX Tests <i>V. Petkov, National Cancer Institute, Rockville, MD, United States</i>
		15 Improving Patient Demographics in Epath Reports and Timely Capture of Clinically Diagnosed Cancer Cases by Linkage with Hospitals' Admission, Discharge, and Transfer (ADT) Data <i>M.A. Lynch, Louisiana Tumor Registry, New Orleans, LA, United States</i>
		16 Probabilistic and Deterministic Data Linkage Between Kentucky Cancer Registry Data and Health Claims Data <i>B. Huang, University of Kentucky, Lexington, Kentucky, United States</i>
		17 Impact of Alternative Data Sources on Projected vs. Actual Case Counts <i>R. Wilson, CDC, Atlanta, GA, United States</i>
E Gateway to Cancer Survival Moderator: Hannah Weir	Sterling 9	18 Construction of a North American Cancer Survival Index to Measure Progress of Cancer Control Efforts <i>C.J. Johnson, Cancer Data Registry of Idaho, Boise, ID, United States</i>
		19 Modelling All-Cause Mortality to Produce Life Tables by Socio-Economic Status for Canadian Provinces <i>D. Spika, London School of Hygiene and Tropical Medicine, London, United Kingdom</i>
		20 Improving the Accuracy of Survival Estimates: Use of the SSA Epidemiology File to Identify Invalid Social Security Numbers <i>P.S. Pinheiro, University of Nevada Las Vegas, School of Community Health Sciences, Las Vegas, NV, United States</i>
F Student Oral Presentations I Moderator: Mai-Chin Hsieh	Grand Ballroom ABCD	S-01 Incidence and Survival of Childhood Brain Tumors in California, 2004-2012 <i>D. Rodriguez, Cancer Registry of Greater California, Public Health Institute, Sacramento, CA, United States University of California Davis, Graduate Group in Epidemiology, Davis, CA, United States</i>
		S-02 Progression Risk After Sphincter-Preserving Operations in Rectal Cancer: A Registry-Based Study from Arkhangelsk, Northwest Russia <i>D. Dubovichenko, Northern State Medical University, Arkhangelsk, Russian Federation</i>
		S-03 Survival from Ovarian Cancer by Morphological Subtype: Data on 676,987 Women in 61 Countries <i>M. Matz, Cancer Research UK Cancer Survival Group, Department of Non-Communicable Disease Epidemiology, London School of Hygiene and Tropical Medicine, London, England</i>
		S-04 Usability Assessment of the Missouri Cancer Registry's Published InstantAtlas Reports Using Health Professionals <i>A. Ben Ramadan, University of Missouri Informatics Institute, Columbia, MO, United States Missouri Cancer Registry and Research Center, Columbia, MO, United States Health Management and Informatics Department/ School of Medicine/ University of Missouri-Columbia, Columbia, MO, United States</i>

4:00pm - 5:30pm Concurrent Session 1 <i>Continued</i>		
G Student Oral Presentations II <i>Moderator:</i> <i>Kyle Ziegler</i>	Sterling 6	S-05 The Association between Insurance Status and Childhood Cancer Survival <i>JM Lee, Brown School, Washington University in St. Louis, St. Louis, MO, United States</i>
		S-06 Incidence of Triple Negative Breast Cancer in New Jersey, 2008-2013 <i>A. Kulkarni, Rutgers School of Public Health, New Brunswick, NJ, United States</i>
		S-07 Multilevel Correlates of In-Hospital Mortality Among Head and Neck Cancer Patients <i>A. Adjei Boakye, Saint Louis University, Saint Louis, MO, United States</i>
		S-08 End-Of-Life Costs of Breast and Cervical Cancer in Missouri's Medicaid Program <i>A. Bouras, School of Medicine Department of Health Management & Informatics (HMI), University of Missouri-Columbia, Columbia, MO, United States Office of Social and Economic Data Analysis (OSED), University of Missouri-Columbia, Columbia, MO, United States MU Informatics Institute, Columbia, MO, United States</i>
5:30pm - 5:45pm	Transition Time and Break to Registry of the Future Open Forum	
5:45pm - 6:30pm	Park View	Registry of the Future Open Forum - Real-Time Reporting Update and Discussion All invited to attend.
6:45pm - 9:00pm	Gateway East & Terrace, Level 18	Opening Reception All conference attendees are encouraged to attend the 2016 Opening Reception. This is a great opportunity to meet with friends and colleagues. You will also be sure to meet new acquaintances and expand your professional network. Local cuisine will be available which will make this a can't miss event! A cash bar will also be available. Kim Massie, St. Louis area blues and soul singer, will perform during the reception.

MOBILE APPLICATION

In keeping with our green initiatives, NAACCR will be utilizing an application for smartphone and tablet users for the 2016 Annual Conference. This application uses Guidebook to offer you much of the same information as the physical program guide in a digital format (and some information not available in the program).

Please use the instructions below to download the guide to your mobile device.



guidebook

Downloading Guidebook

1. Visit your device's app store or marketplace.
2. Search for "Guidebook" in your app store or marketplace.
3. Download and open the free Guidebook application.
4. Search for "NAACCR" using the search bar at the top of the screen.
5. Click on the "NAACCR 2016" guide in the results to download the guide.
6. Once the guide is downloaded, click on "NAACCR 2016" again to open the guide. You can click each of the sections of the guide to view different bits of information about the conference.

Wednesday, June 15

6:30am - 8:00am	Grand Ballroom EFGH	Breakfast	
7:00am - 8:00am	Park View	Birds Of A Feather Round Table Discussion: "Is There Anybody Out There? Collaborating for Cancer Surveillance" Come and share unique, interesting and productive ideas around the topic of collaboration in cancer surveillance. Be sure to bring your breakfast from the exhibit hall to this session. All invited to attend.	
7:00am - 12:00pm	Grand Ballroom EFGH	Exhibit Hall Open	
7:00am - 12:00pm	Grand Ballroom EFGH	Poster Viewing	
7:30am - 11:45am	Prefunction – Fourth Floor	Conference Registration Check In	
8:00am - 9:45am	Plenary Session 3		
Gateway to Information <i>Moderator:</i> <i>Maria Schymura</i>	Grand Ballroom ABCD	8:00am - 8:30am	Natural Language Processing to Support Cancer Registries and Cancer Surveillance <i>Paul A. Fearn, PhD, Director, Biomedical Informatics, Fred Hutchinson Cancer Research Center, Seattle, WA, United States</i>
		8:30am - 9:00am	A New Data Resource for Social Needs <i>Matthew Kreuter, PhD, MPH, Associate Dean for Public Health; Kahn Family Professor of Public Health; and Senior Scientist, Health Communication Research Laboratory, Washington University in St. Louis</i>
		9:00am - 9:30am	Reducing Geographic Disparities: Can Local Breast Cancer Data Identify Where to Target Screening? <i>Mario Schootman, PhD, Associate Dean for Research; James R. Kimmey Endowed Chair in Public Health; Professor of Epidemiology and of Health Services Research and Medicine, St. Louis University</i>
		9:30am - 9:45am	Questions and Discussion
9:45am - 10:15am	Grand Ballroom EFGH	Morning Break, Exhibits, and Poster Viewing	
10:15am - 11:45am	Concurrent Session 2		
A Gateway to Biomarkers for Research <i>Moderator:</i> <i>Xiaocheng Wu</i>	Park View	21	The SEER Virtual Tissue Repository Pilot: Leveraging Population-Based Biospecimens <i>R. Moravec, National Cancer Institute, Rockville, MD, United States</i>
		22	Quality of the KRAS Data in Population-Based Registries for Stage IV Colorectal Cancer Cases <i>M.E. Charlton, University of Iowa College of Public Health, Iowa City, IA, United States State Health Registry of Iowa, Iowa City, IA, United States</i>
		23	Data Federation - A Cancer Registry and a Biobank <i>D.J. Dale, Princess Margaret Cancer Centre, Toronto, ON, Canada</i>
		24	National Program of Cancer Registries – Advancing E-Cancer Reporting and Registry Operations Project (NPCR-AERRO): Electronic Pathology (Epath) and Biomarker Synoptic Reporting Activities <i>S. Jones, Centers for Disease Control and Prevention, Atlanta, GA, United States</i>
B Gateway to Meaningful Use Implementation <i>Moderator:</i> <i>Jim Martin</i>	Regency B	25	The Future of Cancer Registration in the Era of Electronic Health Records <i>J. Rogers, CDC/NPCR, Atlanta, GA, United States</i>
		26	Electronic Physician Reporting to State Cancer Registries ...Present and Future <i>W. Blumenthal, Centers for Disease Control and Prevention, Atlanta, GA, United States</i>
		27	Meaningful Use Cancer Reporting in Maryland: What Do You Mean? <i>C. Groves, Westat, Rockville, MD, United States</i>
		28	Successful Onboarding of Physician Office Data for Meaningful Use Stage 2 Cancer Reporting <i>N. Salahuddin, North Carolina Central Cancer Registry, Raleigh, NC, United States</i>

10:15am - 11:45am Concurrent Session 2 Continued		
C Gateway to Innovative Data Capture <i>Moderator:</i> <i>Chris Johnson</i>	Regency A	29 Development of a Natural Language Processing (NLP) Web Service for Structuring and Standardizing Unstructured Clinical Information <i>S. Jones, Centers for Disease Control and Prevention, Atlanta, GA, United States</i>
		30 Enhancing Capture of Detailed Oral Anticancer Medication Utilization in SEER by Leveraging an External Source of Pharmacy Data <i>Q. Tran, National Cancer Institute, Bethesda, MD, United States</i>
		31 Coordinated Data Development Initiative: Enhancing the Access to and Use of Standardized Treatment Data in Canada <i>C. Louzado, Canadian Partnership Against Cancer, Toronto, ON, Canada</i>
		32 Automated Language Processing of Free Text Medical Reports <i>G. Cernile, Artificial Intelligence in Medicine, Inc., Toronto, ON, Canada</i>
D Gateway to Innovative Operations <i>Moderator:</i> <i>Lynda Douglas</i>	Regency C	33 Web Plus Survivorship Module: Where We Are and Where We Are Going <i>A.B. Ryerson, Division of Cancer Prevention and Control, Centers for Disease Control and Prevention, Atlanta, GA, United States</i>
		34 Usage Patterns of a Web-Based Application Integrating Cancer Registry Data Into Survivorship Care Plans <i>R.C. Vanderpool, University of Kentucky College of Public Health, Lexington, KY, United States</i>
		35 Strategies to Maximize Data Quality Improvements and Enhancements <i>W. Roshala, PHII/Cancer Registry of Greater California, Sacramento, CA, United States</i>
		36 Visualizing a World with Less Cancer <i>R. Rycroft, Colorado Central Cancer Registry, Denver, CO, United States</i>
E Gateway to Scientific Discovery: Virtual Pooled Registry <i>Moderator:</i> <i>David O'Brien</i>	Sterling 9	37 Virtual Pooled Registry Pilot Linkages with Large Cohort Studies <i>C. Clerkin, NAACCR, Springfield, IL, United States</i>
		38 Virtual Pooled Registry Test Linkage Results Using Two Software Systems <i>C. Clerkin, NAACCR, Springfield, IL, United States</i>
		39 Value of a Central Institutional Review Board for Multi-Centered Studies Using the Virtual Pooled Registry <i>S. Stoyanoff, Los Angeles Cancer Surveillance Program, Los Angeles, CA, United States</i>
		40 Value of a Virtual Pooled Registry Process to Improve Data Quality in Central Registries <i>L. Penberthy, NCI, Rockville, MD, United States</i>
11:45am - 12:00pm	Brief Transition Break to Luncheon	
12:00pm - 1:30pm	Grand Ballroom ABCD	NAACCR Luncheon and Awards Ceremony
1:30pm - 2:30pm	Grand Ballroom ABCD	NAACCR Business Meeting All conference delegates are asked to attend the 2016 NAACCR Business Meeting. Voting Delegates from their respective organizations are required to attend the NAACCR Business Meeting.
2:30pm	Wednesday Adjournment	

Wednesday, June 15

2:30pm - 3:30pm	Grand Ballroom ABCD	New Updates/FORDS Manual Updates (All Welcome) Frederick L. Greene, MD FACS, Chair of the Commission on Cancer FORDS Manual revision process, will update the attendees and outline the implication of the process for all who depend on modern coding for cancer care and research. The importance of adding codes pertaining to recurrence of cancer will be stressed. The new name for the FORDS manual will be introduced! Audience participation is encouraged.
3:30pm - 5:30pm	Regency A	Cancer Surveillance Strategies in the Caribbean (Invitation Only)
4:00pm	Bike Event Meet in Hyatt Regency At The Arch lobby. The NAACCR Wednesday Fun Bike Ride. Come join us for a leisurely bike ride around St. Louis!	
5:00pm - 6:00pm	Park View	CONCORD Meeting (Invitation Only)
6:30pm - 8:00pm	Regency A	NCCCS Meeting (Invitation Only)
6:15pm Game Start	St. Louis Cardinals Game Outing Take advantage of the short stroll to Busch Stadium and watch as the St. Louis Cardinals take on the Houston Astros! Tickets needed to be purchased prior. See St. Louis Cardinals website for tickets.	





www.explorestlouis.com

There's so much to see and do in St. Louis, we thought we'd start you out with a few "must-see options."

- Ride to the top of the Gateway Arch, towering 630-feet over the Mississippi River.
- Enjoy world-class free attractions, including the Art Museum, Zoo, Science Center, Anheuser-Busch Brewery, Grant's Farm and the Missouri History Museum.
- Marvel at the Missouri Botanical Garden, one of the world's top public gardens.
- Free your inner child at The Magic House, St. Louis Children's Museum, the City Museum and other kid-friendly attractions.
- Cheer for the MLB's Cardinals and NHL's Blues.
- Flirt with Lady Luck at one of the area's six casinos.
- Experience live blues music in dozens of area clubs and taverns.
- Visit the heart of St. Louis through our friendly and charming neighborhoods.
- Take in the art at Laumeier Sculpture Park, the Contemporary Art Museum, the Pulitzer Foundation for the Arts, and The Sheldon Concert Hall, Ballroom & Art Galleries.
- Re-discover your heritage at the Old Courthouse, Griot Museum of Black History and Culture and Faust Historic Village.
- Visit the world-famous Budweiser Clydesdales at the Anheuser-Busch Brewery.
- Visit an artistic oasis in the heart of downtown. Citygarden offers a vibrant blending of lush plantings and internationally renowned sculpture.
- Fill an extra suitcase during a shopping trip through major malls and antique and collectible stores.
- Check out Ballpark Village across from Busch Stadium.
- Get an adrenaline rush on the world-class roller coasters and thrill rides at Six Flags St. Louis.
- Play Scott Joplin's ragtime tunes at the composer's historic home.
- Talk to the animals at Grant's Farm, Purina Farms, the Wild Canid Survival Center, the World Bird Sanctuary and the Saint Louis Zoo.
- Cruise the mighty Mississippi River on the Tom Sawyer or Becky Thatcher paddle wheeler.
- Count the mosaics at the breathtaking Cathedral Basilica of Saint Louis.

Thursday, June 16

6:30am	Meet in Hyatt hotel lobby	NAACCR 2016 Run/Walk NAACCR encourages all attendees to participate in the NAACCR run/walk. It is estimated that over half of cancer cases can be prevented by lifestyle changes such as exercise, the limitation of tobacco use, and improved nutrition. Meet in the hotel lobby to enjoy a nice walk or jog to start your day off right!
6:30am - 8:00am	Grand Ballroom EFGH	Breakfast
7:00am - 11:30am	Prefunction – Fourth Floor	Conference Registration Check In
7:00am - 3:30pm	Grand Ballroom EFGH	Exhibit Hall Open
7:00am - 3:30pm	Grand Ballroom EFGH	Poster Viewing
8:00am - 9:30am	Concurrent Session 3	
A Gateway to Research: Colorectal Cancer <i>Moderator: Marta Induni</i>	Park View	41 Trends in Colorectal Cancer Incidence in Younger Canadians, 1969-2010 <i>P. De, Cancer Care Ontario, Toronto, ON, Canada</i>
		42 The Risk of Colorectal Cancer is Increasing in Successive Birth Cohorts Since the Early 1950s <i>R. Siegel, American Cancer Society, Atlanta, GA, United States</i>
		43 Geographic Variation of Advanced Stage Colorectal Cancer in California <i>J. Rico, California Department of Public Health/California Cancer Registry, Sacramento, CA, United States</i>
B Gateway to Innovative Data Use I <i>Moderator: Lori Koch</i>	Regency B	44 Meaningful Use in Practice: What Reporters Think <i>J. Martin, Virginia Cancer Registry, Richmond, VA, United States</i>
		45 Implementing Cancer Case Reporting from Ambulatory Electronic Health Records <i>A.A. Austin, New York State Cancer Registry, Albany, NY, United States</i>
		46 Assessment of the National Program of Cancer Registries (NPCR) Program Evaluation Instrument (PEI) <i>S. Van Heest, Centers for Disease Control and Prevention, Atlanta, GA, United States</i>
C Gateway to Cancer Control <i>Moderator: Sandy Jones</i>	Regency A	47 Annual Versus Biennial Mammography Screening and Stage at Diagnosis of Breast Cancer in Illinois <i>T.A. Dolecek, University of Illinois at Chicago, Chicago, IL, United States</i>
		48 Gateway to Information: Using Data Visualization to Create Interactive Profiles for Cancer in Missouri by State Senatorial District <i>J. Jackson-Thompson, Missouri Cancer Registry and Research Center, Columbia, MO, United States University of Missouri (MU) School of Medicine Department of Health Management & Informatics, Columbia, MO, United States MU Informatics Institute, Columbia, MO, United States</i>
		49 Breast Cancer Prevention Among American Indian/Alaska Native Women in Missouri <i>M. Taffa, T. Sparks, S. Kloeckner and S. Taluc, Kathryn M. Buder Center for American Indian Studies / Brown School of Social Work, Washington University in St. Louis, St. Louis, MO, United States</i>

8:00am - 9:30am		Concurrent Session 3 Continued	
<div>D</div> <div>Gateway to Improved Stage Data</div> <div>Moderator: Linda Mulvihill</div>	Regency C	50	NPCR'S TNM Stage Calculator: A Tool for Central Registry Quality Control and Consolidation Assistance <i>J. Seiffert, Northrop Grumman, Atlanta, GA, United States</i>
		51	Comparison of TNM Assigned by Physicians Compared with Registry Reviewer Assigned: Results from a SEER Field Study <i>P. Adamo, National Cancer Institute, Bethesda, MD, United States</i>
		52	A Central Registry Reliability Study to Gauge Visual Editor TNM and Summary Stage Coding Skills <i>D. Hansen, California Cancer Registry, Sacramento, CA, United States</i>
		53	Evaluation of Directly Coded AJCC Stage Data: One Large State's Experience <i>M.J. Schymura, New York State Cancer Registry, Albany, NY, United States</i>
		54	Combined T, N, and M Based on Directly Coded Clinical and Pathologic T, N, and M: Evaluation of the Derivation Algorithm and Opportunities for Registrar Education and Computer Edits <i>P. Adamo, National Cancer Institute, Bethesda, MD, United States</i>
<div>E</div> <div>Gateway to Identifying Disparities</div> <div>Moderator: Deidre Rogers</div>	Sterling 9	55	Racial and Socio-Economic Disparities in Melanoma Incidence Rates in Georgia: 2000-2011 <i>M. Culp, CDC, Atlanta, GA, United States ORISE, Oak Ridge, TN, United States</i>
		56	Cancer-Specific Mortality and Racial Disparities Among Cancer Patients with Diabetes Mellitus <i>C. Lam, National Cancer Institute, Rockville, MD, United States</i>
		57	Survival Trends by Socioeconomic Status, 1998-2011: A Shift in Disparities for Colorectal Cancer Survival <i>D. Holt, Westat, Rockville, MD, United States</i>
		58	Examining Income Disparities in Lung Cancer Incidence, Mortality and Survival in Canada <i>S. Fung, Canadian Partnership Against Cancer, Toronto, ON, Canada</i>
9:30am - 9:45am	Grand Ballroom EFGH	Morning Break, Exhibits, and Poster Viewing	
9:45am - 11:30am		Plenary Session 4	
<div>Gateway to Scientific Discovery</div> <div>Moderator: Betsy Kohler</div>	Grand Ballroom ABCD	9:45am - 10:15am	Integrating Population Sciences into Cancer Center Research <i>Eduardo J. Simoes, MD, MSc, DLSHTM, MPH, Chair and Health Management and Informatics Alumni; Distinguished Professor, Department of Health Management and Informatics, University of Missouri (MU) School of Medicine</i>
		10:15am - 10:45am	Translating Research into Clinical Practice in Hepatocellular Cancer <i>Kevin Staveley-O'Carroll, MD, PhD, Chair of the Hugh E. Stephenson Jr., MD, Dept. of Surgery, University of Missouri (MU) School of Medicine and Director of MU's Ellis Fischel Cancer Center</i>
		10:45am - 11:15am	Future of Cancer Surveillance - CDC Perspective <i>Chesley Richards, MD, MPH, FACP, Deputy Director, Office of Public Health Scientific Services, CDC</i>
		11:15am - 11:30am	Questions and Discussion

Thursday, June 16

11:30am - 12:30pm		Concurrent Session 4	
<div>A</div> <div>Gateway to HIV and Cancer</div> <div>Moderator: Meg Watson</div>	Park View	59	Contributions of HIV to Non-Hodgkin Lymphoma Mortality in the U.S. (2005-2012) <i>E.A. Engels, National Cancer Institute, Bethesda, MD, United States</i>
		60	HIV Infection Is Associated with Low 5-Year Relative Survival for Cancer Patients in Louisiana <i>X.R. Li, Louisiana Tumor Registry, Epidemiology Program, LSUHSC, New Orleans, LA, United States</i>
		61	Trends in Primary Central Nervous System Lymphoma Incidence and Survival in the U.S. <i>M. Shiels, National Cancer Institute, Rockville, MD, United States</i>
<div>B</div> <div>Gateway to Building a Research Program</div> <div>Moderator: Winnie Roshala</div>	Regency B	62	Enhancing Cancer Registry Research Recruitment Through Clinical Trial Applications: A Collaboration Between NJSCR and Clinical Performance Partners, Inc. <i>N. Herman, New Jersey State Cancer Registry, Trenton, NJ, United States Rutgers Cancer Institute of New Jersey, New Brunswick, NJ, United States</i>
		63	Accuracy of Self-Reported Cancer Diagnosis from the MY-Health Study Cohort Compared with Participating SEER Cancer Registries <i>N. Herman, New Jersey State Cancer Registry, Trenton, NJ, United States Rutgers Cancer Institute of New Jersey, New Brunswick, NJ, United States</i>
		64	New Jersey's Research Management Solution: Our Gateway to Successful Population-Based Cancer Research <i>C.J. Harrell, CJH Consulting, Brighton, UT, United States</i>
<div>C</div> <div>Gateway to Zombies and Immortals</div> <div>Moderator: Castine Clerkin</div>	Regency A	65	Finding "Immortals": Can Statistical Models Help? <i>D. Nishri, Cancer Care Ontario, Toronto, ON, Canada</i>
		66	Finding "Zombies" in Your Registry Database by Confirming Source Record Vital Status <i>D.K. O'Brien, Alaska Cancer Registry, Anchorage, AK, United States</i>
		67	Utilizing State Databases to Improve Follow-up: The Louisiana Vaccination Experience <i>C. Lefante, Louisiana Tumor Registry, New Orleans, LA, United States LSU Health Sciences Center; School of Public Health, New Orleans, LA, United States</i>
<div>D</div> <div>Gateway to New Data Standards</div> <div>Moderator: Jim Hofferkamp</div>	Regency C	68	NAACCR V.16 Edits Metafile Update <i>J. Hofferkamp, CTR, NAACCR, Springfield, IL, United States</i>
		69	AJCC Cancer Staging Manual, 8th Edition Update <i>D. Gress, AJCC, Chicago, IL, United States</i>
		70	Timing is the Key to AJCC TNM Staging <i>D. Gress, AJCC, Chicago, IL, United States</i>
<div>E</div> <div>Gateway to Global Initiatives in Surveillance</div> <div>Moderator: Brenda Edwards</div>	Sterling 9	71	Trends in the Incidence of Thyroid Cancer, Israel, 1990-2012 <i>B.G. Silverman, Israel National Cancer Registry, Israel Center for Disease Control, Israel Ministry of Health, Tel HaShomer, Israel School of Public Health, Sackler Faculty of Medicine, Tel Aviv University, Tel Aviv, Israel</i>
		72	Leading Causes of Cancer-Specific Mortality in the Caribbean Region <i>H. Razzaghi, CDC, Atlanta, GA, United States</i>
		73	Subsite of the Colon Cancer and Survival in 2000-2013: A Population-Based Analysis from the Arkhangelsk Oblast, North-Western Russia <i>M.Y. Valkov, Northern State Medical University, Arkhangelsk, Russian Federation Clinical Oncology Center, Arkhangelsk, Russian Federation</i>
		74	World-Wide Variation in Breast Cancer Survival by Age, Stage and Morphology <i>C. Allemani, London School of Hygiene and Tropical Medicine, London, United Kingdom</i>
12:30pm - 1:30pm		Lunch on Your Own	

1:30pm - 3:00pm Concurrent Session 5		
A Gateway to Vulnerable Populations <i>Moderator:</i> Angela Martin	Park View	75 Disparities in Cancer Incidence and Survival Between Indigenous and Non-Indigenous Adults in Canada: Follow-up of the 1991 Canadian Census Cohort <i>D. Nishri, Cancer Care Ontario, Toronto, ON, Canada</i>
		76 Cancer Incidence and Mortality Patterns Among Chinese Americans <i>D. Deapen, Los Angeles Cancer Surveillance Program, University of Southern California, Los Angeles, CA, United States</i>
		77 Racial Disparities in Cancer Incidence, Staging, and Survival Among the Oldest Old in the United States <i>J. Krok-Schoen, Comprehensive Cancer Center, The Ohio State University, Columbus, OH, United States</i>
		78 The Alaska Native Tumor Registry: 45 Years of Cancer Surveillance Among Alaska Native People <i>S.H. Nash, Alaska Native Tribal Health Consortium, Anchorage, AK, United States</i>
B Gateway to Geospatial Applications <i>Moderator:</i> Bruce Riddle	Regency B	79 Evaluation of Commercial Data Sources for Obtaining Individual Residential Histories for Cancer Research <i>D. Stinchcomb, Westat, Inc., Rockville, MD, United States</i>
		80 Easy Interactive Mapping of Cancer Data Revisited <i>J.E.A. Bartholomew, Geowise Limited, Edinburgh, United Kingdom</i>
		81 Responding to Community Concerns Regarding Cancer Incidence - The Role of the Israel National Cancer Registry <i>B.G. Silverman, Israel National Cancer Registry, Israel Center for Disease Control, Israel Ministry of Health, Tel HaShomer, Israel School of Public Health, Sackler Faculty of Medicine, Tel Aviv University, Tel Aviv, Israel</i>
		82 Estimating Neighbourhood-Level Behavioural Risk Factor Prevalence from Large Population-Based Surveys: A Bayesian Approach <i>L. Seliske, Cancer Care Ontario, Toronto, ON, Canada</i>
C Gateway to Cancer Epidemiology II <i>Moderator:</i> Chester Schmaltz	Regency A	83 Differences Between Hispanic and Non-Hispanic White Breast Cancer Patients: Molecular Subtypes and Survival <i>R.D. Cress, Public Health Institute, Cancer Registry of Greater California, Sacramento, CA, United States</i>
		84 Socio-Demographic Predictors of Survival Among Acute Myelogenous Leukemia Patients in California, 2003-2012 <i>J. Morgan, Loma Linda University School of Public Health, Loma Linda, CA, United States SEER Cancer Registry of Greater California, Loma Linda, CA, United States</i>
		85 Invasive Cancer Incidence and Survival — United States, 2012 <i>S. Singh, CDC, Atlanta, GA, United States</i>
		86 Collection of Occupation and Industry Information through National Program of Cancer Registries Comparative Effectiveness Research Study <i>M. Culp, CDC, Atlanta, GA, United States ORISE, Oak Ridge, TN, United States</i>
D Gateway to Minimizing Death Certificate Only Cases <i>Moderator:</i> Joseph Rogers	Regency C	87 Use of Information Systems to Support NAACCR Death Clearance Standards <i>L. Gijjahn, Ohio Department of Health, Columbus, OH, United States</i>
		88 Exploring the Efficacy of Using Disease Index to Improve Cancer Registry Data Completeness and Death Clearance Casefinding in Maryland <i>W. Ross, Westat, Rockville, MD, United States</i>
		89 Text: Can it Reduce Your DCO Burden? Youbetcha! <i>L. Stephenson, Wisconsin Cancer Reporting System, Division of Public Health, Madison, WI, United States</i>
		90 Analysis of External Databases to Ascertain Vital Status <i>S. Van Heest, Centers for Disease Control and Prevention, Atlanta, GA, United States</i>

Thursday, June 16

1:30pm - 3:00pm		Concurrent Session 5 Continued	
<div>E</div> <div>Gateway to Using Insurance Information</div> <div>Moderator: Frank Boscoe</div>	Sterling 9	91 Sorting Out the Primary Payer Jumble, Part A: The Montana Experience <i>L. Williamson, Montana Central Tumor Registry, Helena, MT, United States</i>	
		92 Sorting Out the Primary Payer Jumble, Part B: The U.S. Experience <i>R.L. Sherman, NAACCR, Springfield, IL, United States</i>	
		93 Disparities in Quality of Care and Outcomes Among Cancer Patients in California: The Role of Health Insurance and Population Demographics <i>A. Parikh-Patel, California Cancer Reporting and Epidemiologic Surveillance (CalCARES) Program, Institute for Population Health Improvement, UC Davis Health System, Sacramento, CA, United States</i>	
		94 Augmenting Kentucky Cancer Registry Data with Medicare, Medicaid and Private Insurance Claims Data <i>B. Huang, University of Kentucky, Lexington, KY, United States</i>	
<div>F</div> <div>Gateway to Innovative Data Use II</div> <div>Moderator: Iris Zachary</div>	Grand Ballroom ABCD	95 Pitfalls and Opportunities Using Cancer Registry Data for Thyroid Cancer Research <i>M.A. Whiteside, Tennessee Department of Health, Nashville, TN, United States</i>	
		96 IASLC 2011 and WHO 2015 Classifications of Lung Adenocarcinomas: Demographic Patterns, Trends, and Implications for Cancer Surveillance <i>S. Negoita, Westat, Rockville, MD, United States</i>	
		97 Using Cancer Registry Data to Estimate the Percentage of Melanomas Attributable to UV Exposure <i>M. Watson, CDC, Atlanta, GA, United States</i>	
3:00pm - 3:30pm	Grand Ballroom EFGH	Afternoon Break with Refreshments, Exhibits, and Poster Viewing	
3:20pm - 3:30pm	Grand Ballroom EFGH	Poster Removal	
3:30pm - 4:00pm	Grand Ballroom EFGH	Exhibit Breakdown	
3:30pm - 4:30pm		Plenary Session 5	
<div>Gateway to Patient Centeredness and Patient Perspectives</div> <div>Moderator: Nan Stroup</div>	Grand Ballroom ABCD	3:30pm - 4:00pm	Palliative Care and End-Of-Life Decision Making: The Impact of Population-Based Cancer Data <i>Clay Anderson, MD, FACP, NorthCare Hospice & Palliative Care</i>
		4:00pm - 4:15pm	Questions and Discussion
<div>Late Breaker Session</div>	Grand Ballroom ABCD	4:15pm - 4:45pm	Using Registry Data; Creating Cancer Control Indicators and the New CINA Public Data Set <i>Recinda Sherman, PhD, Program Manager of Data Use and Research, NAACCR</i> Caribbean Hub for the Global Initiative for Cancer Registries <i>Glennis Andall-Brereton, PhD, Epidemiologist/Senior Technical Officer, Caribbean Public Health Agency CARPHA</i>
4:45pm - 5:00pm	Grand Ballroom ABCD	<div>Invitation to 2017 Meeting - Albuquerque, NM</div> <i>Dr. Charles Wiggins, New Mexico Tumor Registry</i>	
5:00pm - 5:15pm	Grand Ballroom ABCD	<div>Closing Remarks and Adjournment</div>	

Program-at-a-Glance

TIME	MONDAY, JUNE 13	TUESDAY, JUNE 14	WEDNESDAY, JUNE 15	THURSDAY, JUNE 16	TIME	
6:30 am				NAACCR 2015 5K RUN/WALK Meet in Hotel Lobby: 6:30 am	6:30 am	
7:00			BIRDS OF A FEATHER ROUNDTABLE Park View, Level 4: 7:00 am - 8:00 am		7:00	
7:30					7:30	
8:00				8:00		
8:30			KEYNOTE ADDRESS Grand Ballroom ABCD, Level 4: 8:30 am - 9:30 am	PLENARY SESSION 3 Gateway to Information Grand Ballroom ABCD, Level 4: 8:00 am - 9:45 am	CONCURRENT SESSION 3 Various Rooms: 8:00 am - 9:30 am	8:30
9:00		BREAK/POSTER/EXHIBITS: 9:30 am - 10:00 am	BREAK/POSTERS/EXHIBITS: 9:45 am - 10:15 am	9:00		
9:30				BREAK Grand Ballroom EFGH: 9:30 am - 9:45 am	9:30	
10:00		PLENARY SESSION 1 Gateway to Implementation and Results Grand Ballroom ABCD, Level 4: 10:00 am - 12:00 pm	CONCURRENT SESSION 2 Various Rooms: 10:15 am - 11:45 am	PLENARY SESSION 4 Gateway to Scientific Discovery Grand Ballroom ABCD, Level 4: 9:45 am - 11:30 am	10:00	
10:30				CONCURRENT SESSION 4 Various Rooms: 11:30 am - 12:00 pm	10:30	
11:00					LUNCH ON OWN/POSTER/EXHIBITS Grand Ballroom EFGH, Level 4: 12:30 pm - 1:30 pm	11:00
11:30					11:30	
12:00 pm	COMMUNICATIONS STEERING COMMITTEE MEETING (PAN) Mills 8, Level 4: 12:00 pm - 1:00 pm STANDARDIZATION & REGISTRY DEVELOPMENT STEERING COMMITTEE MEETINGS (PAN) Sterling 9, Level 2: 1:00 pm - 2:30 pm RESEARCH & DATA USE STEERING COMMITTEE MEETING (PAN) Mills 8, Level 4: 2:30 pm - 4:00 pm PROFESSIONAL DEVELOPMENT STEERING COMMITTEE MEETING (PAN) Sterling 9, Level 2: 4:00pm - 5:00 pm	LUNCH ON OWN POSTERS/EXHIBITS 12:00 pm - 1:15 pm	LUNCHEON & AWARDS CEREMONY Grand Ballroom ABCD, Level 4: 12:00 pm - 1:30 pm		12:00 pm	
12:30					12:30	
1:00			MTC REGISTERED LUNCHEON Gateway East, Level 18			1:00
1:30			PLENARY SESSION 2 Gateway to Diversity Grand Ballroom ABCD, Level 4: 1:15 pm - 3:30 pm	NAACCR BUSINESS MEETING Grand Ballroom ABCD, Level 4: 1:30 pm - 2:30 pm		1:30
2:00				CONCURRENT SESSION 5 Various Rooms: 1:30 pm - 3:00 pm		2:00
2:30		NEW UPDATES/FORDS MANUAL UPDATES Grand Ballroom ABCD, Level 4: 2:30 pm - 3:30 pm			2:30	
3:00		BREAK/POSTER/EXHIBITS: 3:30 pm - 4:00 pm		BREAK/POSTER/EXHIBITS: 3:00 pm - 3:30 pm	3:00	
3:30					3:30	
4:00		CONCURRENT SESSION 1 Various Rooms: 4:00 pm - 5:30 pm		CLOSING PLENARY SESSION 5 Gateway to Patient Centeredness & Patient Perspectives Grand Ballroom ABCD, Level 4: 3:30 pm - 4:30 pm	4:00	
4:30			NAACCR BIKE EVENT Meet in Hotel Lobby, 4:00 pm		4:30	
5:00	Exhibitor Showcase and Poster Pre-Viewing Grand Ballroom EFGH, Level 4: 5:00 pm - 7:00 pm	REGISTRY OF THE FUTURE OPEN FORUM Park View, Level 4: 5:45 pm - 6:30 pm		CLOSING REMARKS & ADJOURNMENT	5:00	
5:30					5:30	
6:00					6:00	
6:30	NAACCR Program Committee Reception Grand Ballroom EFGH, Level 4: 6:30 pm - 7:00 pm	OPENING RECEPTION Gateway East & Terrace, Level 18: 6:30 pm - 9:00 pm	ST. LOUIS CARDINAL GAME OUTING 6:15 pm Game Start		6:30	
7:00					7:00	

Plenary Sessions

Concurrent Sessions

Committee Meetings

Other Sessions

Break/Lunch

Awards Luncheon

Breaks: Grand Ballroom EFGH